

電話設定 - Vivo

Phone Settings - Vivo



TRAILME

電話設定目標

Objective of Phone Settings

- 開啟藍牙
Turn ON Bluetooth
- 開啟流動網絡
Turn ON Mobile network
- 開啟定位服務
Turn ON Location
- 開啟通知
Turn ON all Notifications
- 允許權限
Allow all Permissions
- 電池使用「正常模式」
Turn ON Battery - "Normal mode"
- 開啟「允許打擾」
Turn ON 'Allow to interrupt'



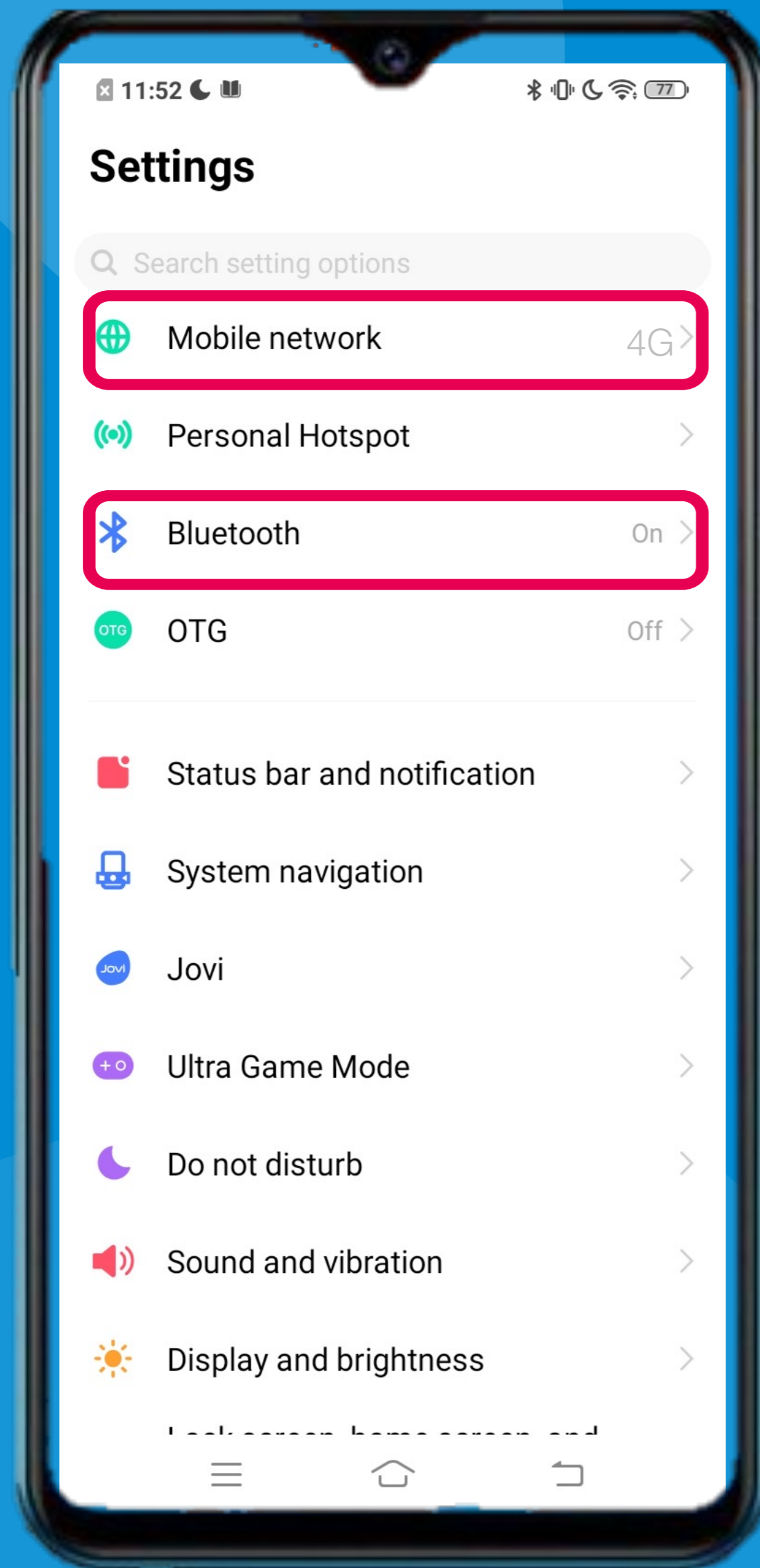

「設定」→ 開啟藍牙及流動網絡

'Settings' → Turn ON Bluetooth and Mobile Network



TRAILME

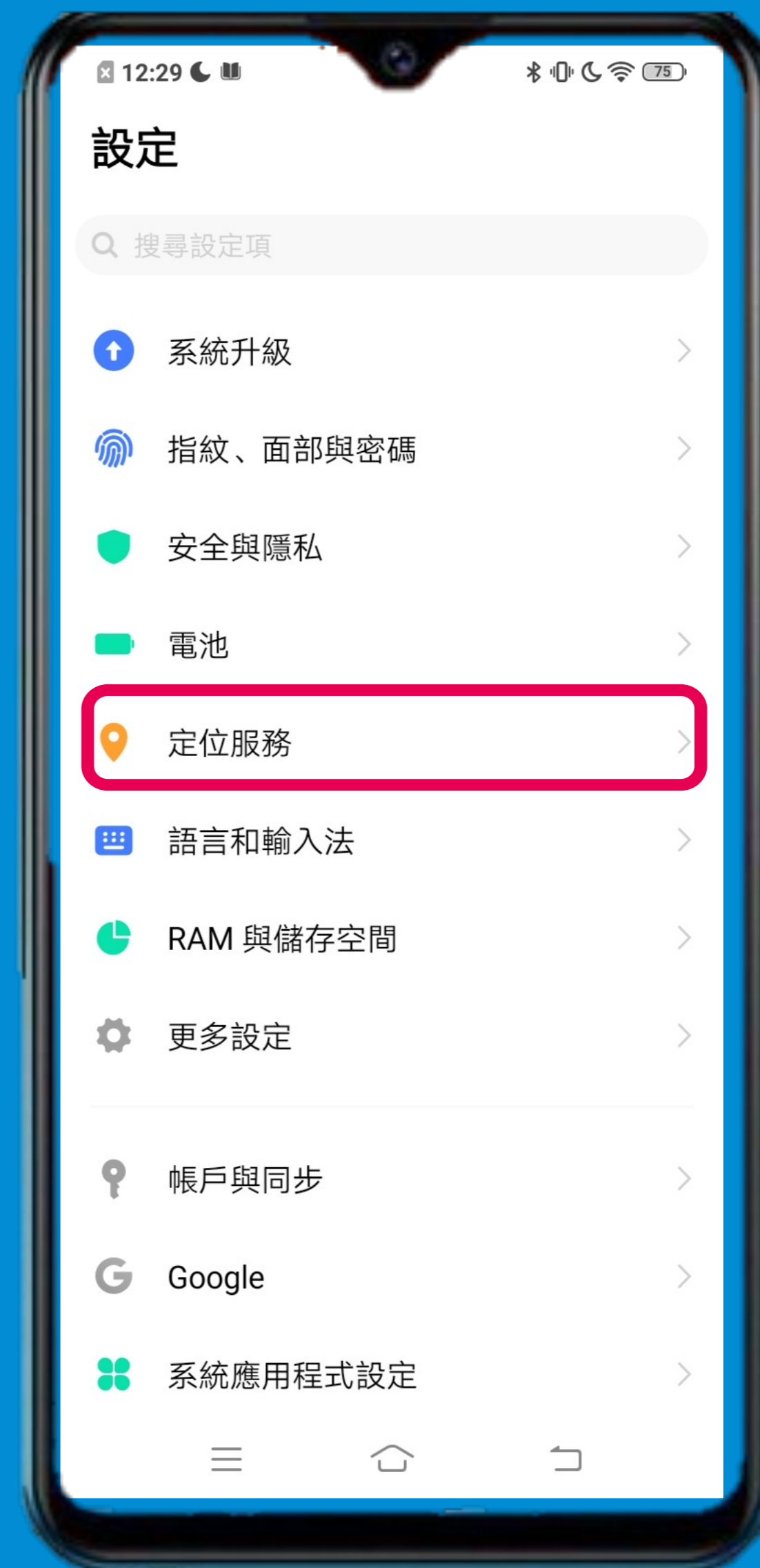
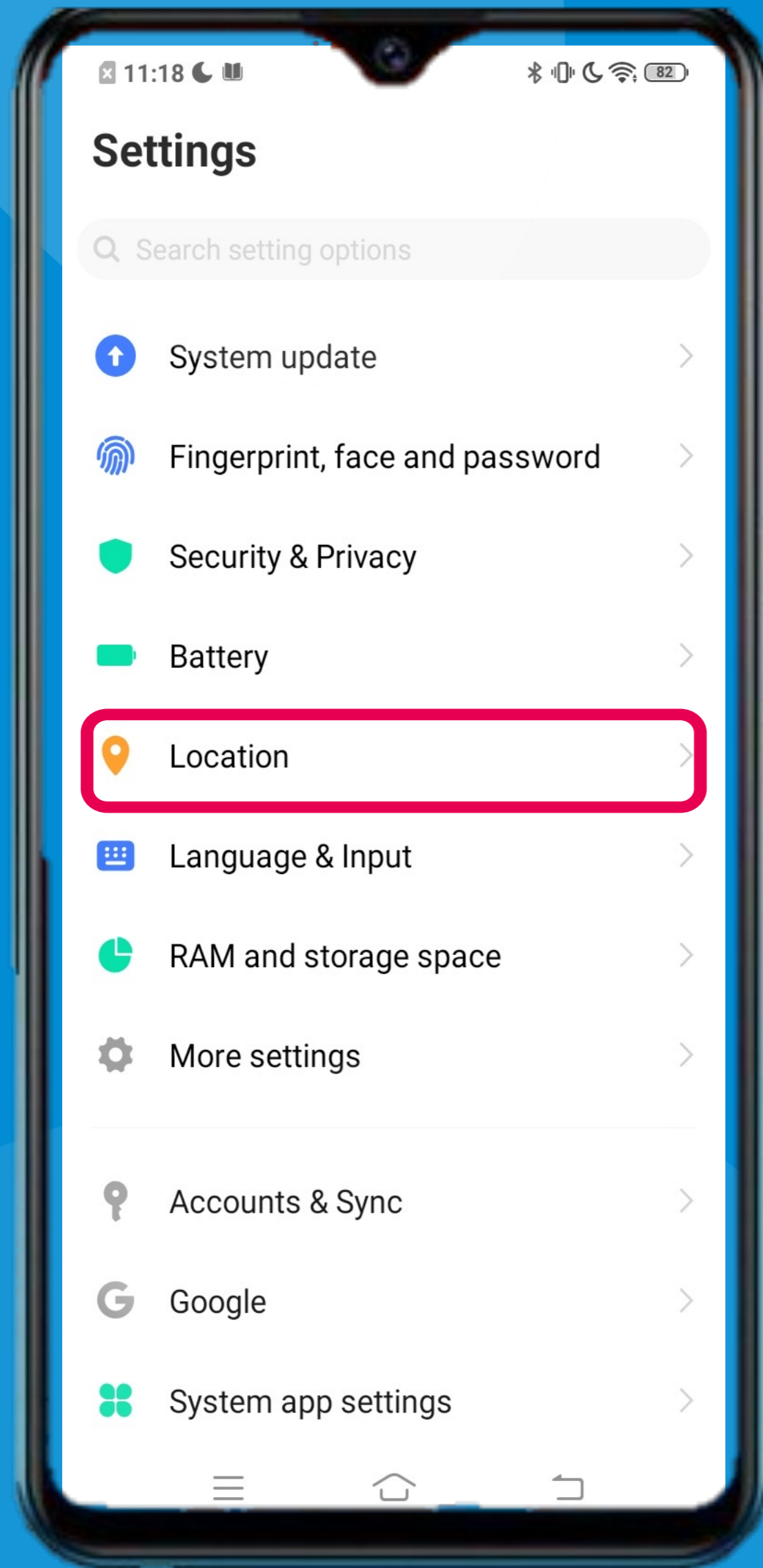

「設定」→ 選擇 '定位服務'
'Settings' → Select 'Location'

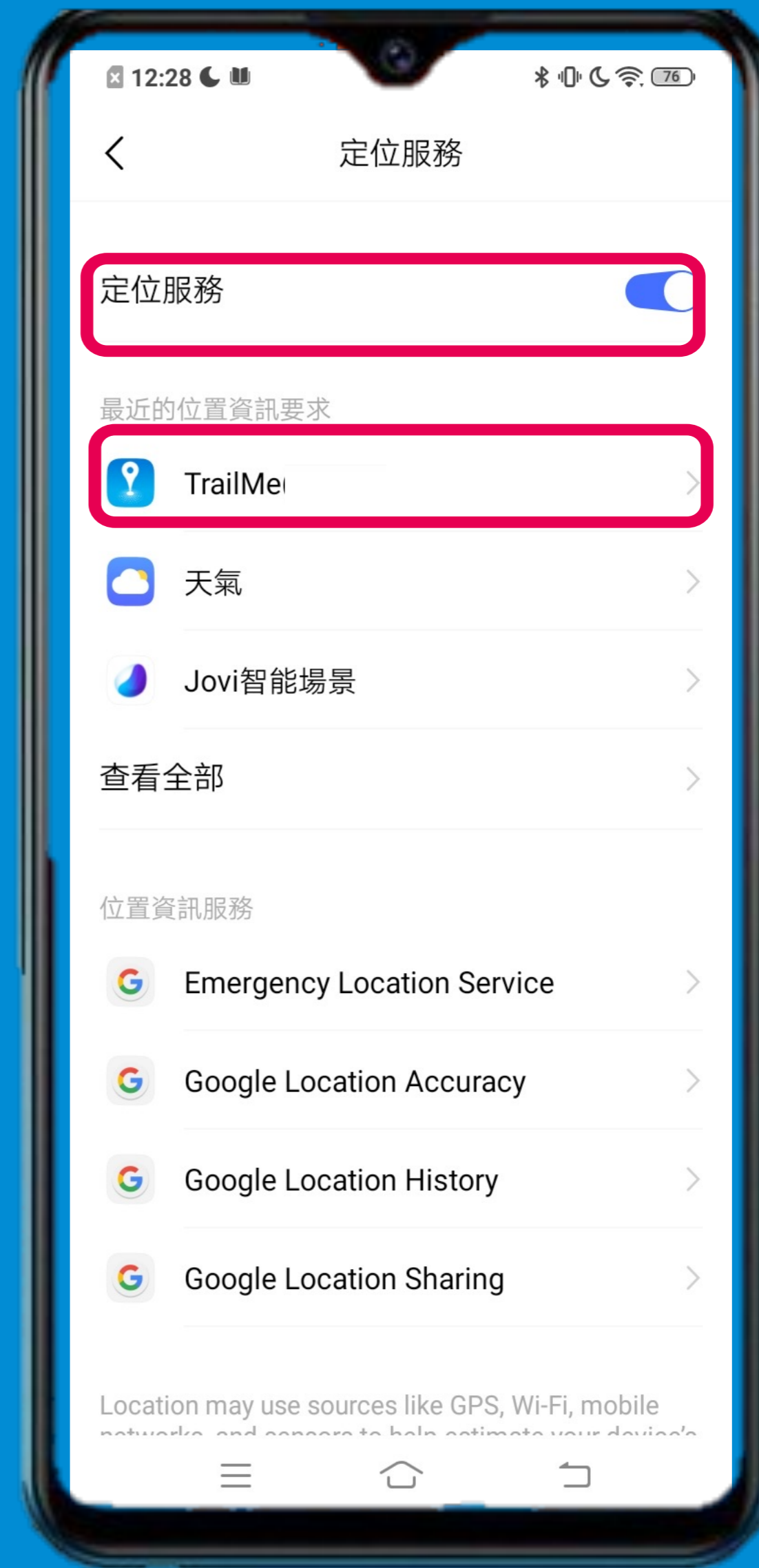
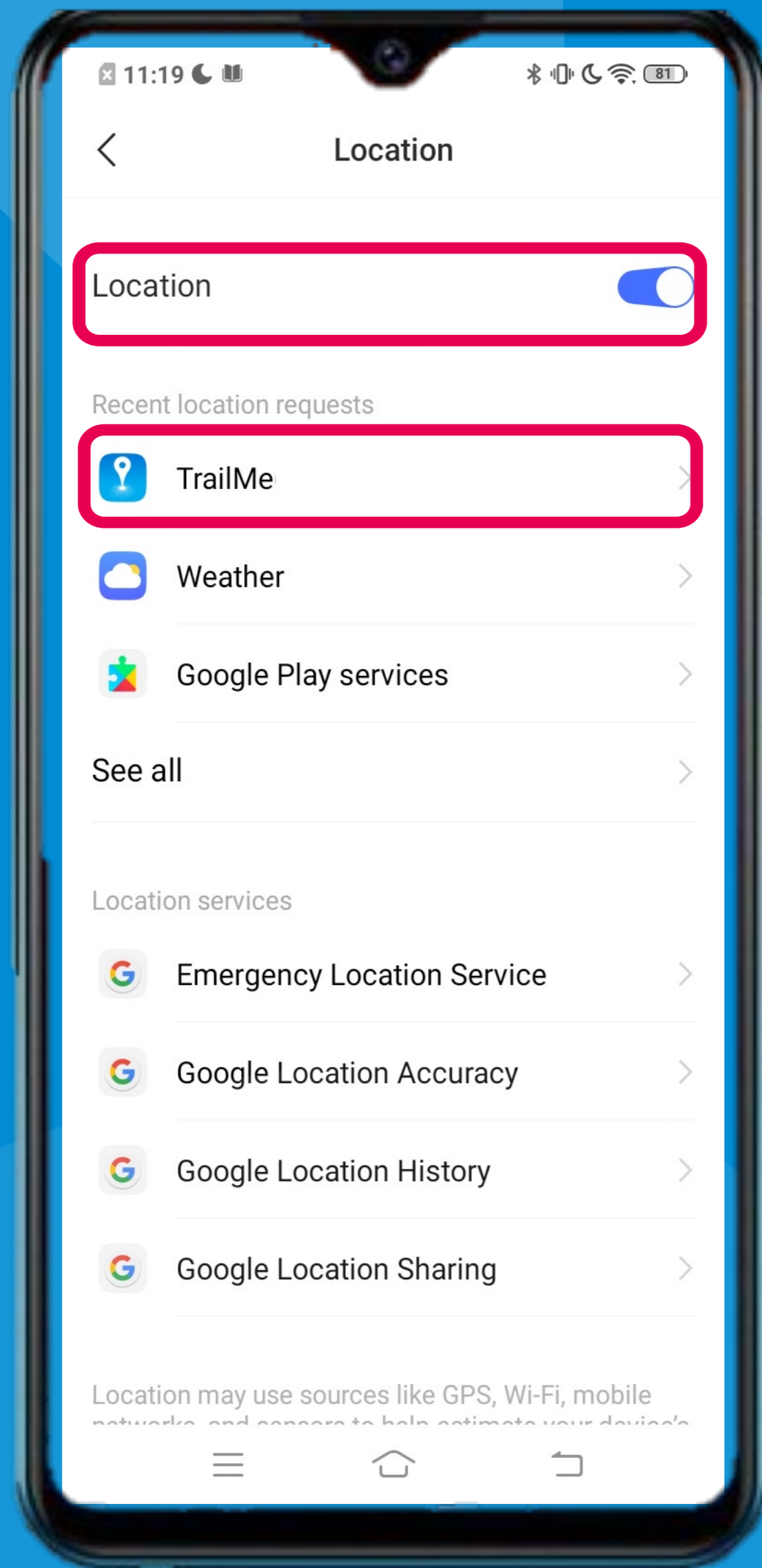

開啟定位服務及選擇TRAILME
Turn On "Location" and select TRAILME

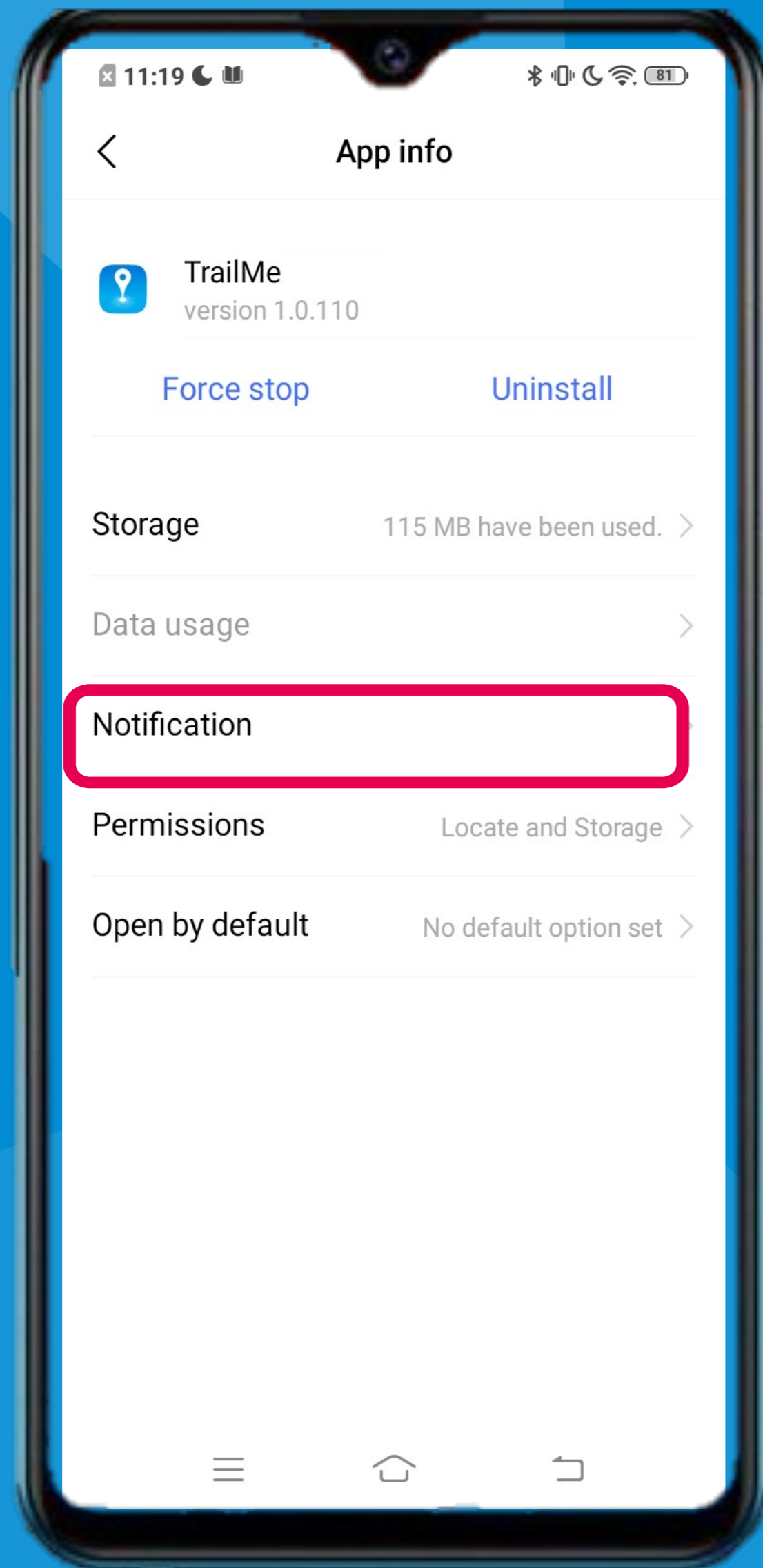

'TRAILME' → 選擇「通知」
'TRAILME' → Select 'Notification'

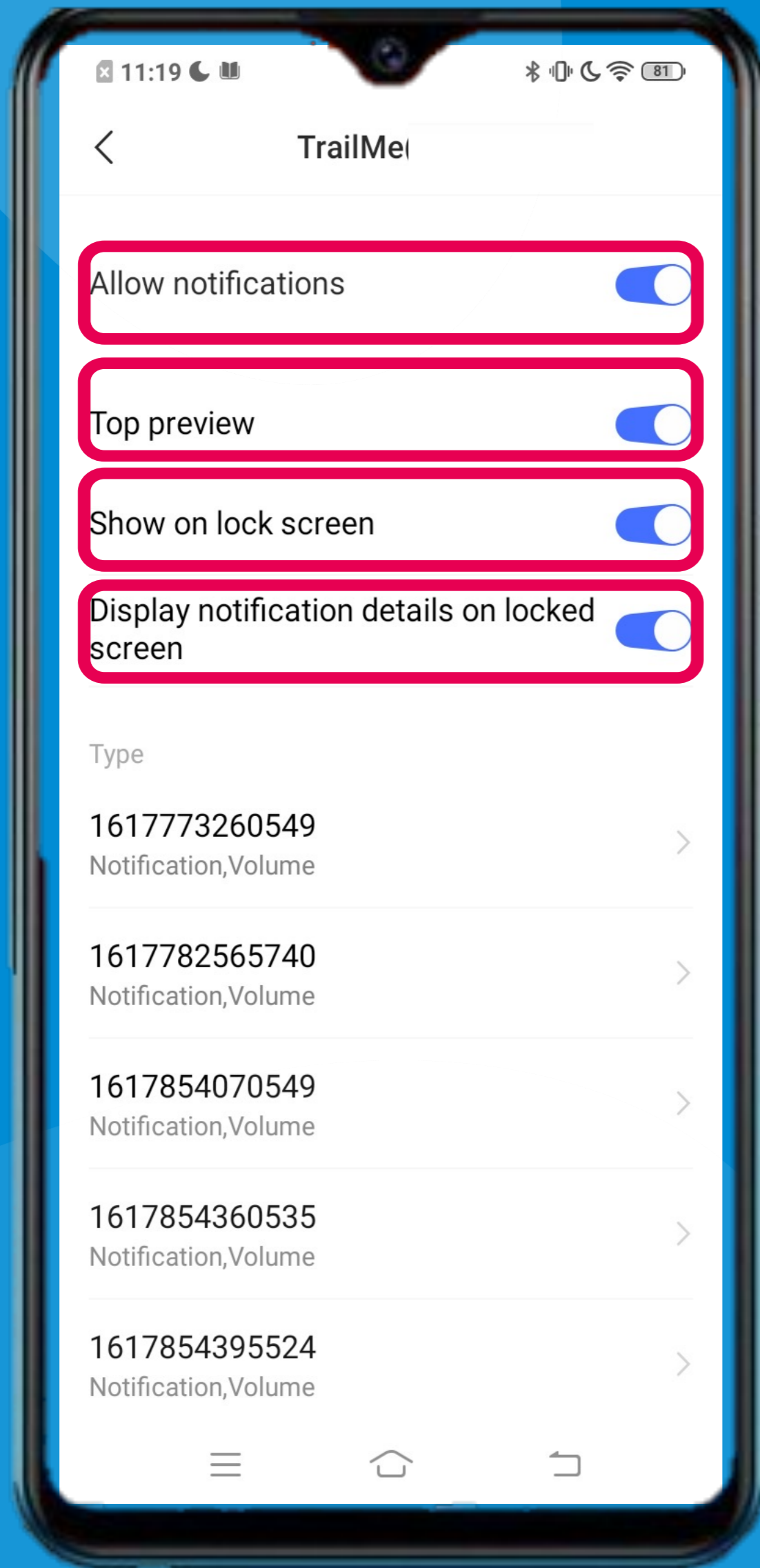

開啟全部通知
Turn ON all notifications

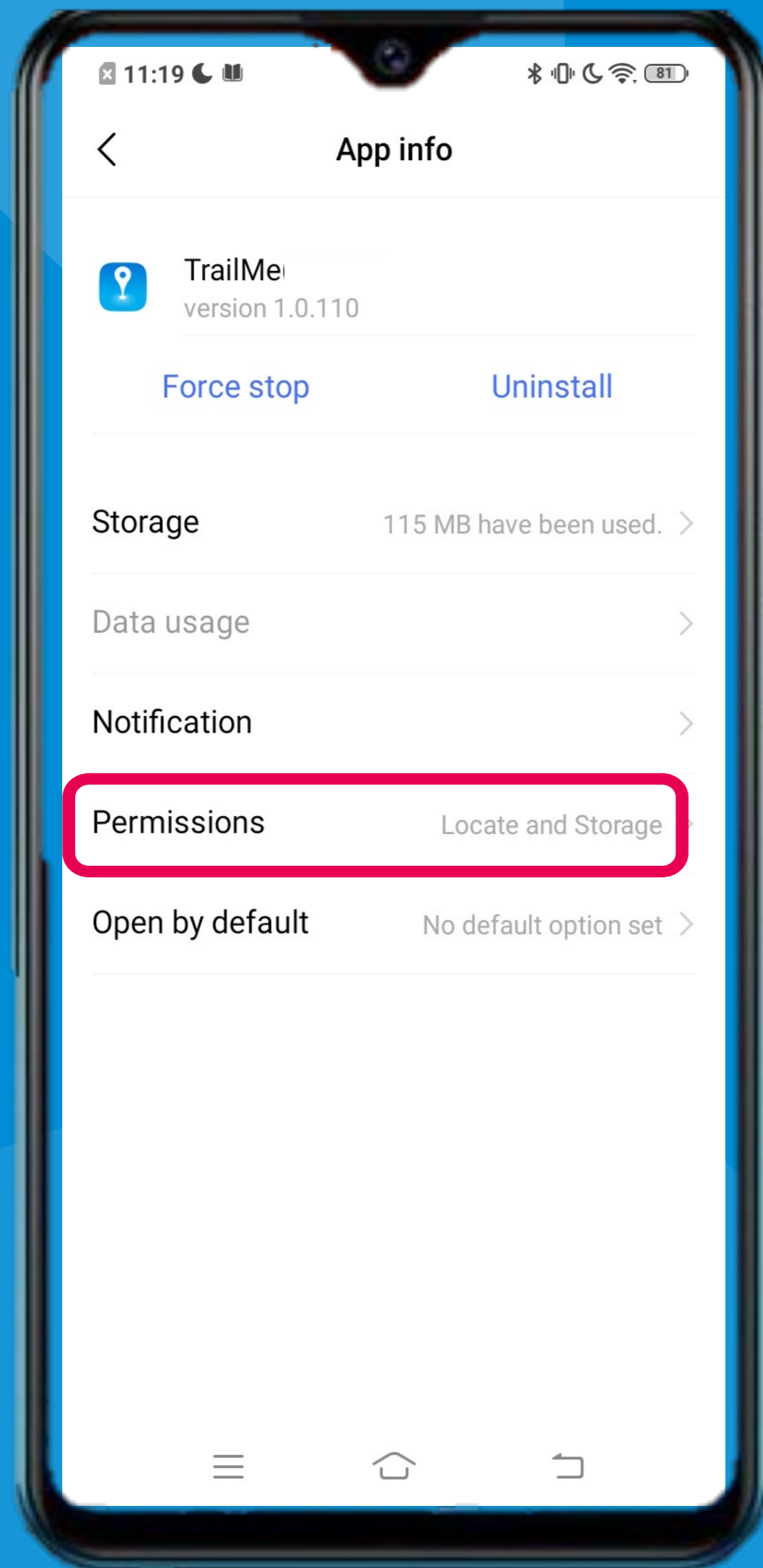

'TRAILME' → 選擇「權限」
'TRAILME' → Select 'Permissions'



允許所有權限
Allow all permissions

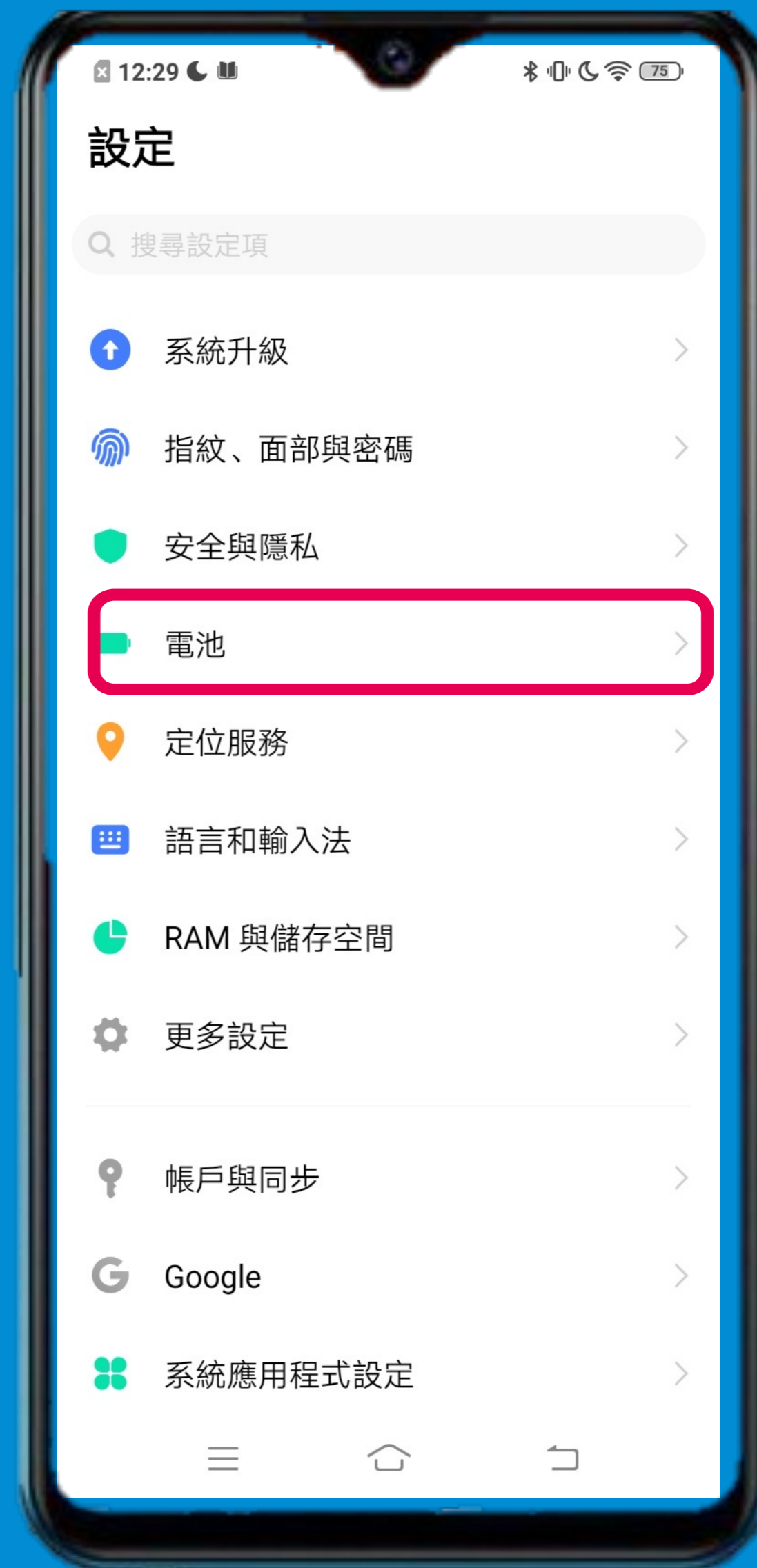
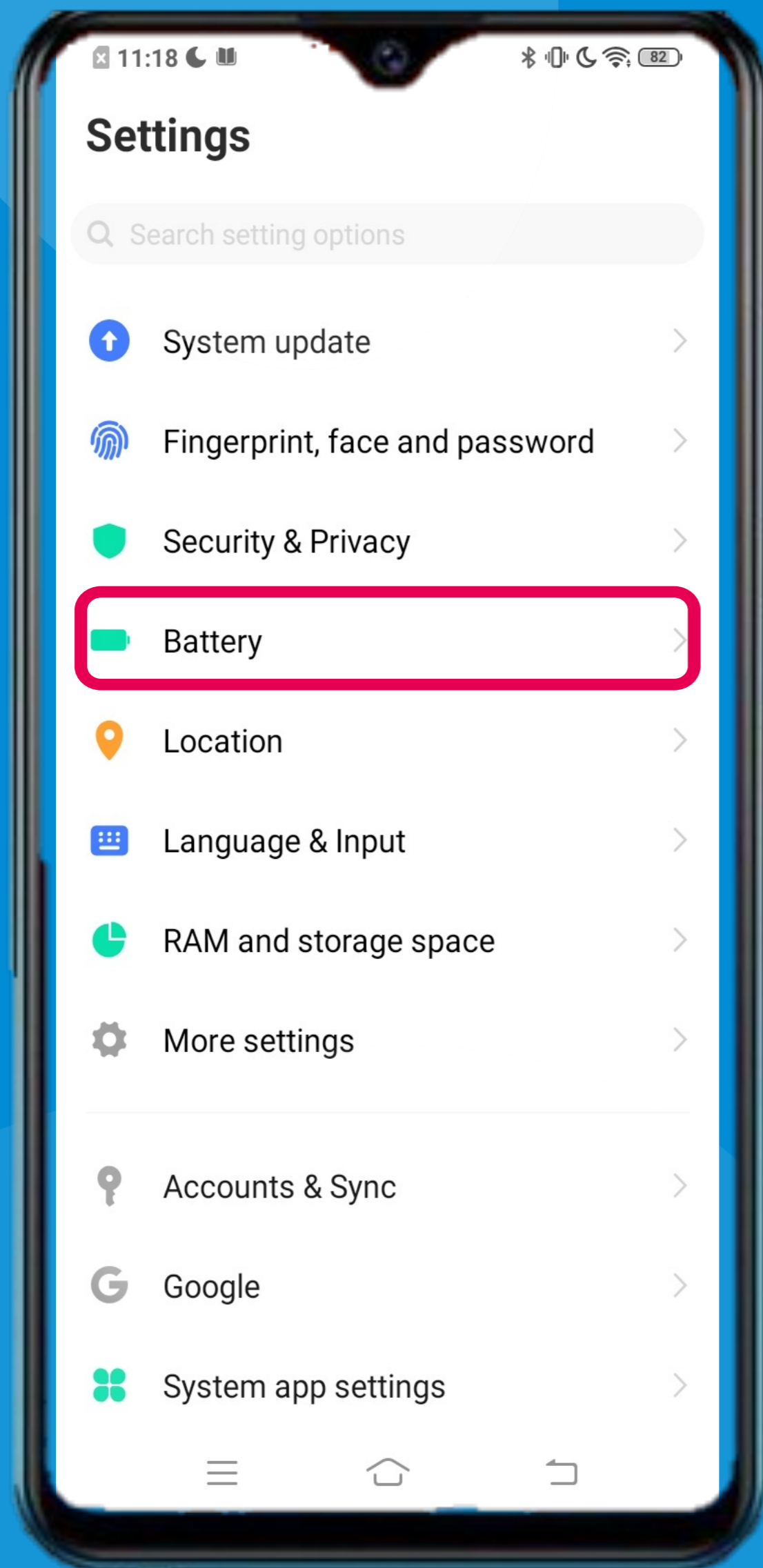

「設定」→ 選擇 '電池'
'Settings' → Select 'Battery'

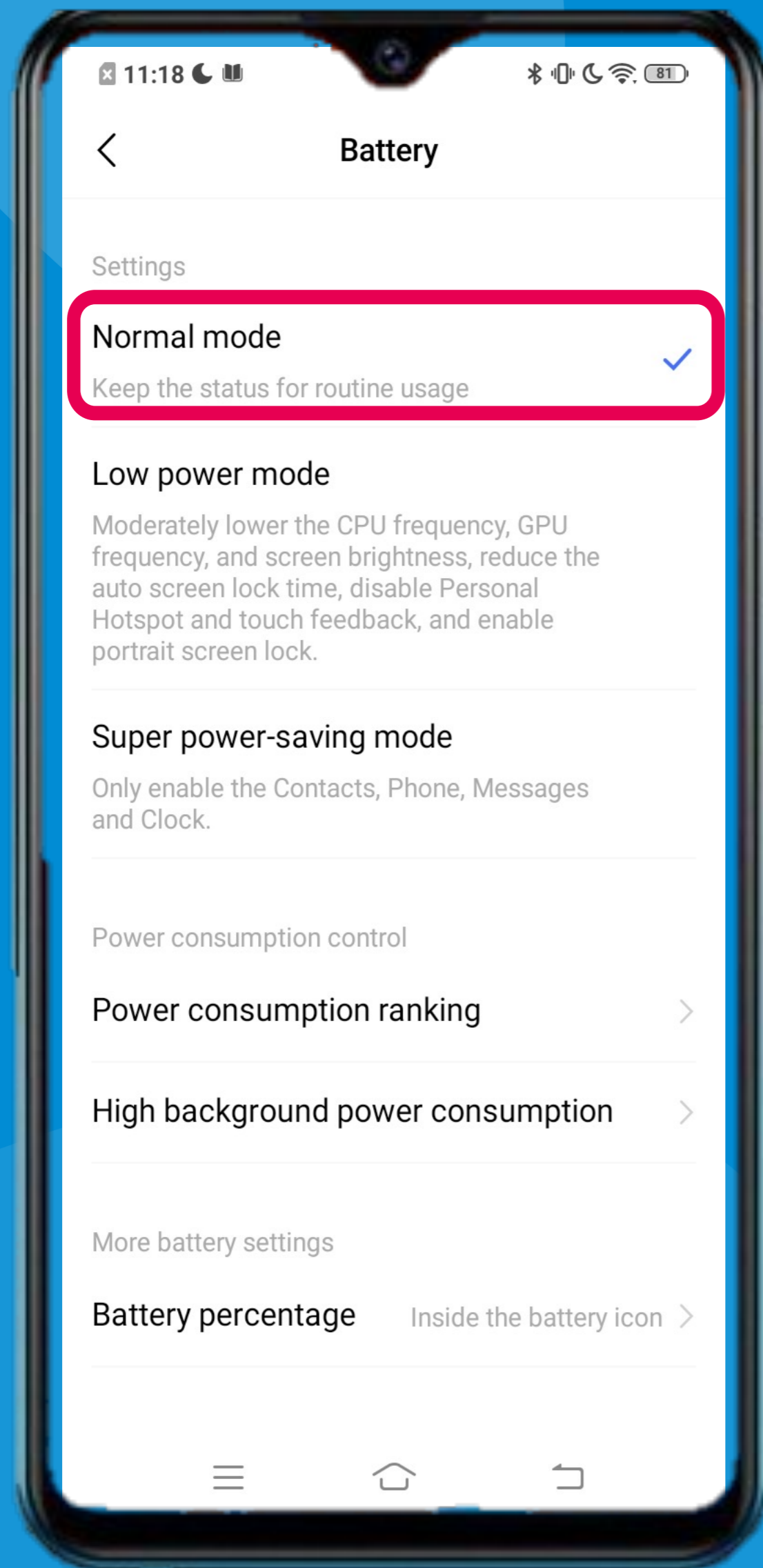

'電池' → 選擇 '正常模式'
'Battery' → 'Select 'Normal mode'

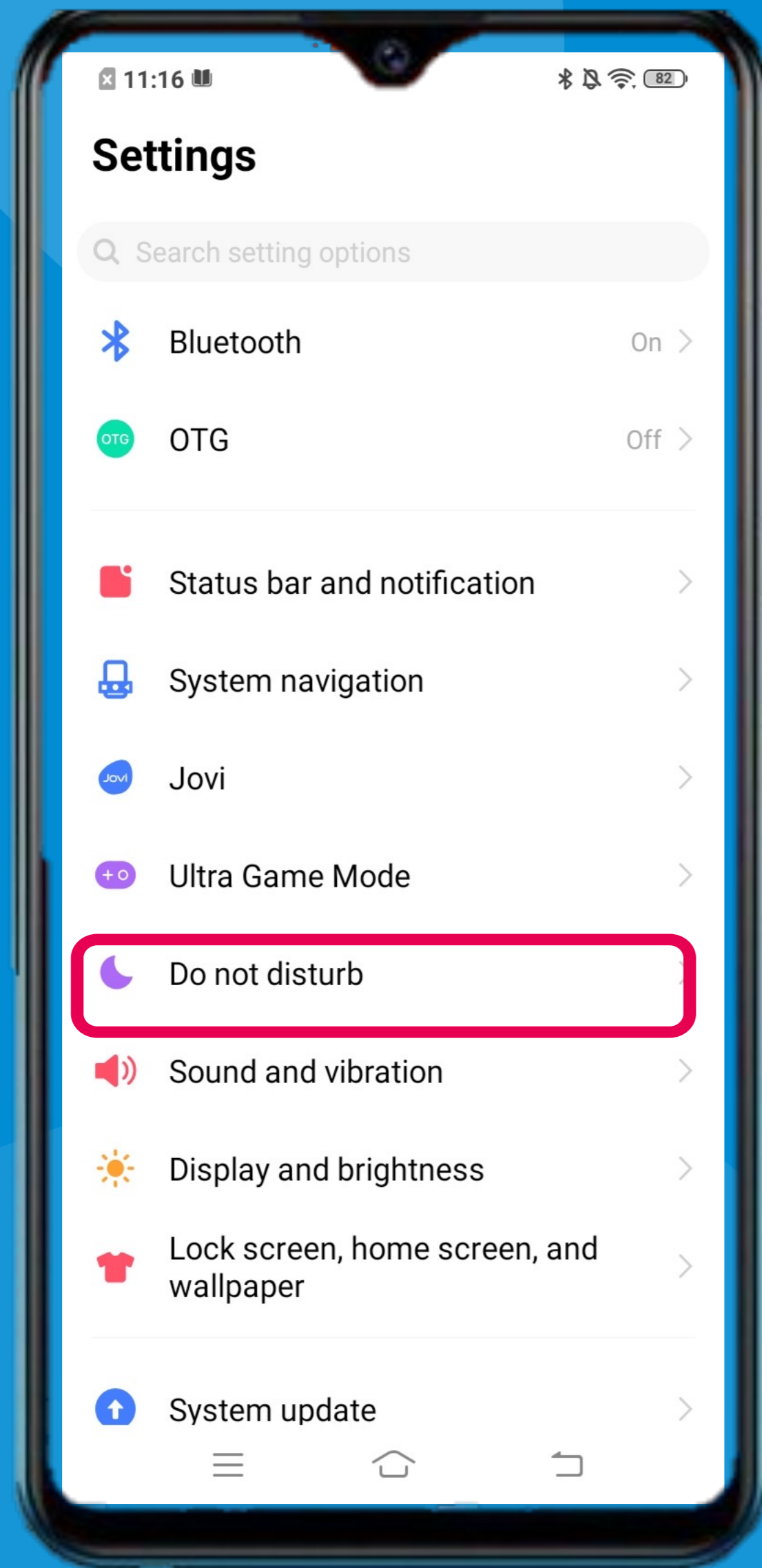

「設定」→ 選擇「請勿打擾」
'Settings' → Select 'Do not disturb'

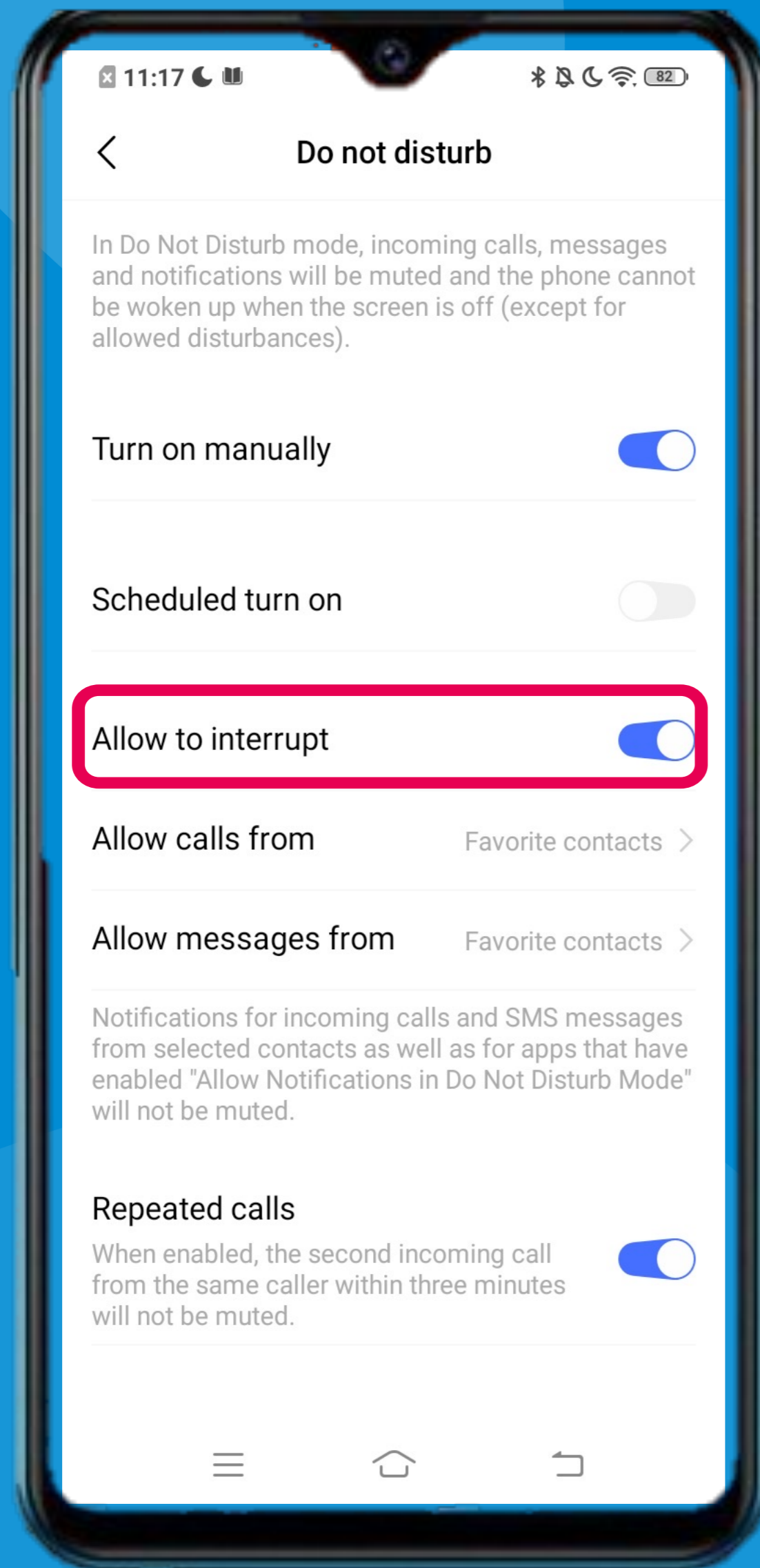

開啟 '允許打擾'
Turn ON 'Allow to interrupt'



TRAILME