

# 電話設定 - HTC

## Phone Settings - HTC



**TRAILME**

# 電話設定目標

## Objective of Phone Settings

- 開啟藍牙  
Turn ON Bluetooth
- 開啟流動網絡  
Turn ON Mobile network
- 開啟位置及藍牙掃描  
Turn ON Location and Bluetooth scanning
- 關閉電池的「極致省電模式」  
Turn OFF Battery - "Extreme power saving mode"
- 開啟通知  
Turn ON notifications
- 允許權限  
Allow permissions
- 關閉「請勿打擾」偏好設定  
'Sound & notification' → Turn OFF 'Do Not Disturb preferences'



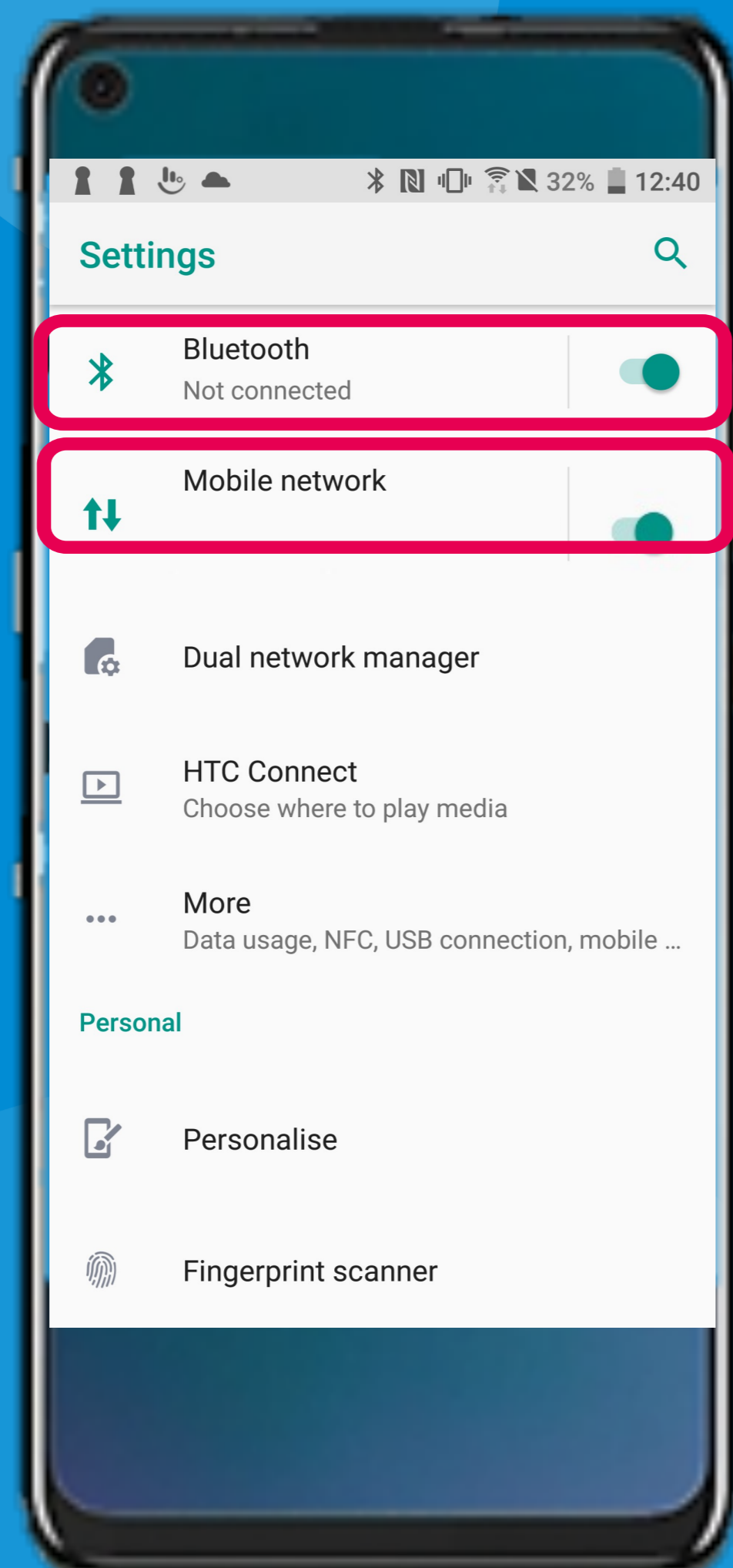

「設定」→ 開啟藍牙及流動網絡  
'Settings' → Turn ON Bluetooth and Mobile Network

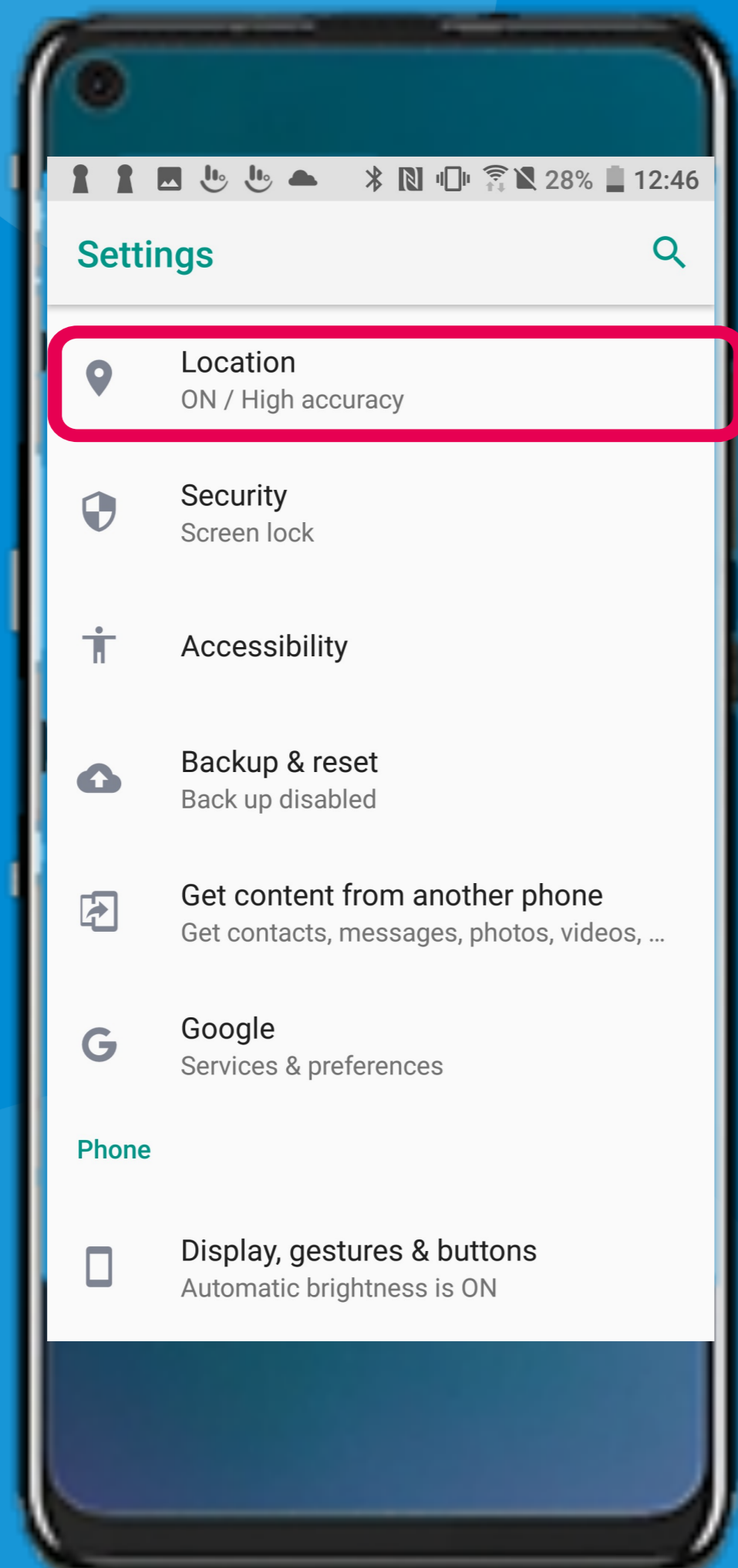

「設定」→「位置」  
'Settings' → 'Location'

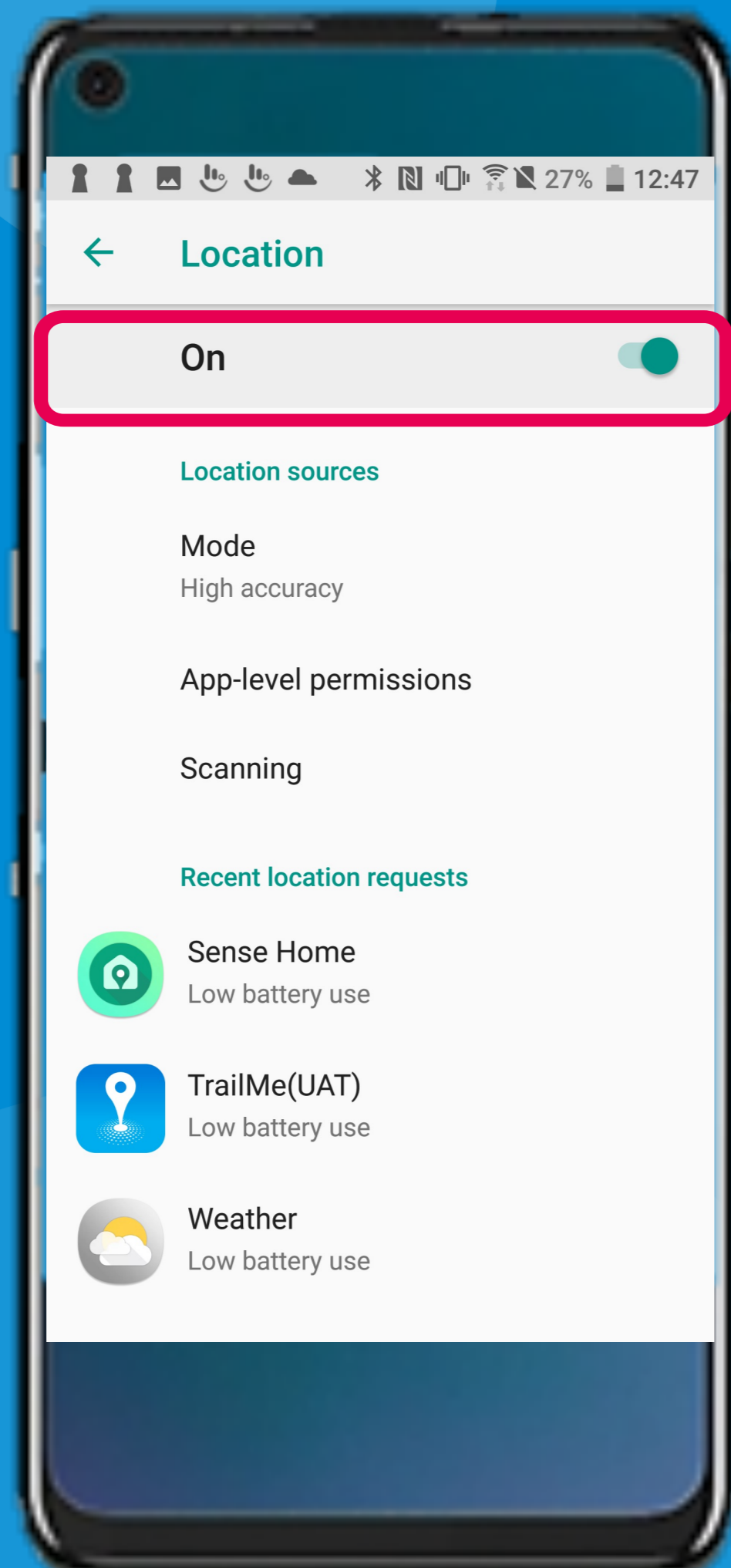

「位置」→ 開啟「位置」  
'Location' → Turn ON 'Location'

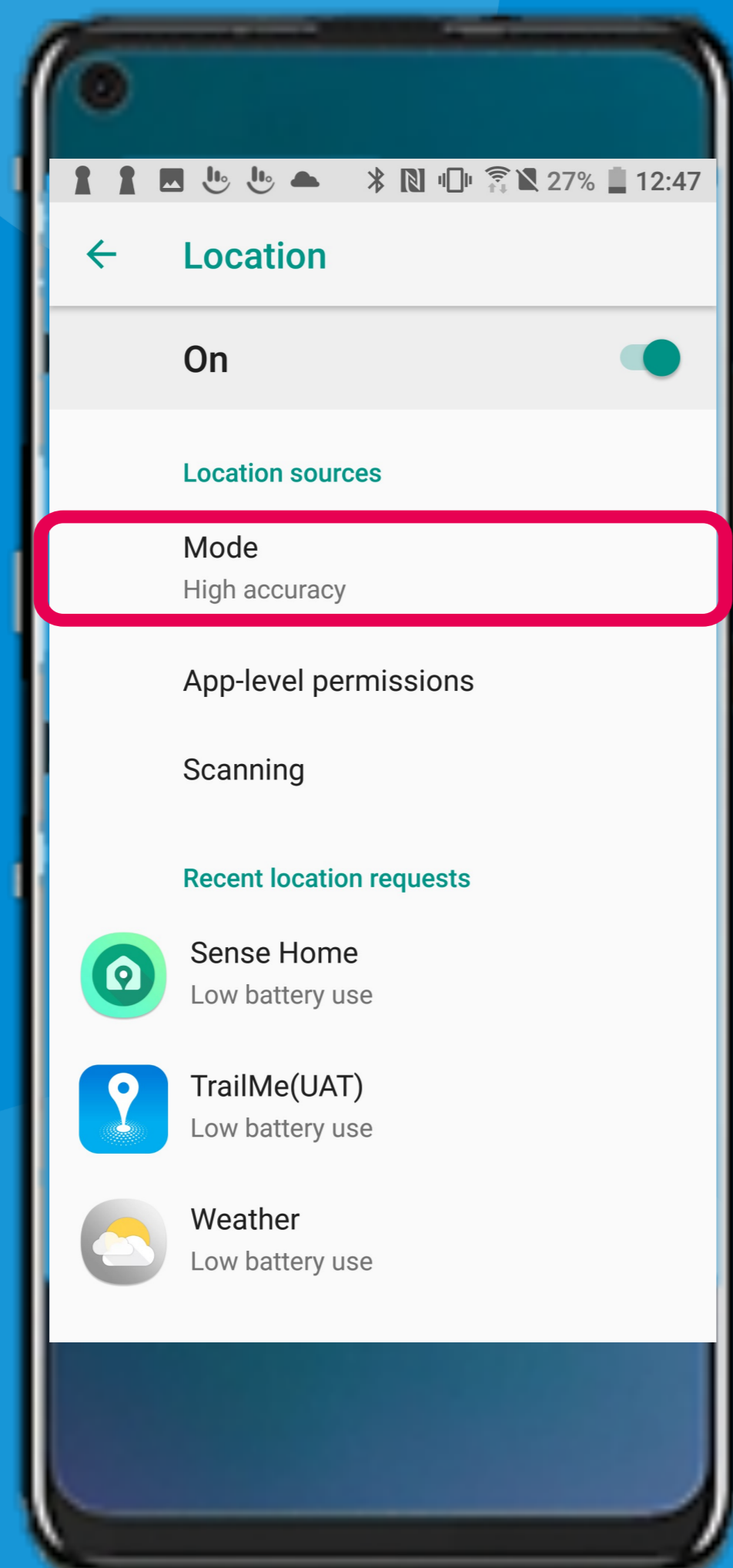

「位置」→「模式」  
'Location' → 'Mode'

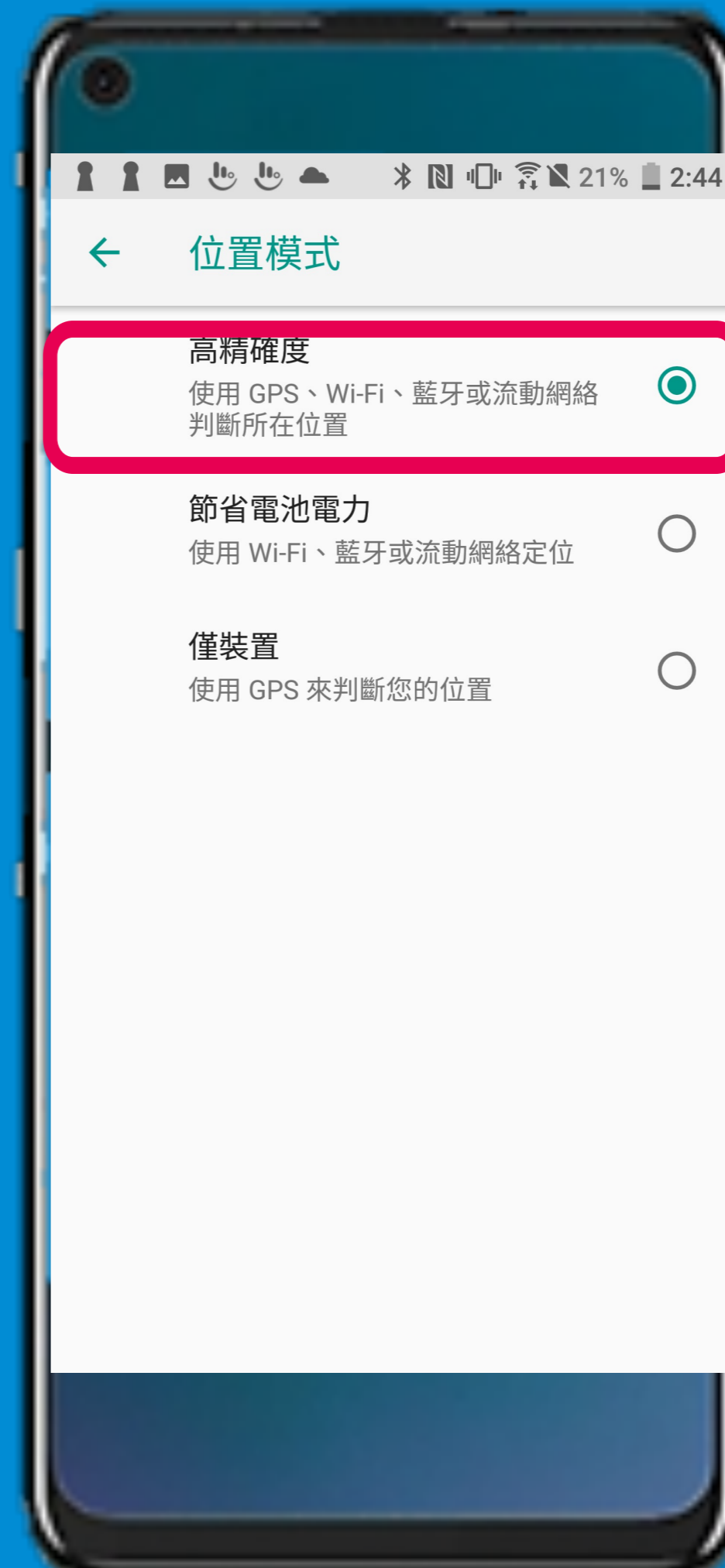
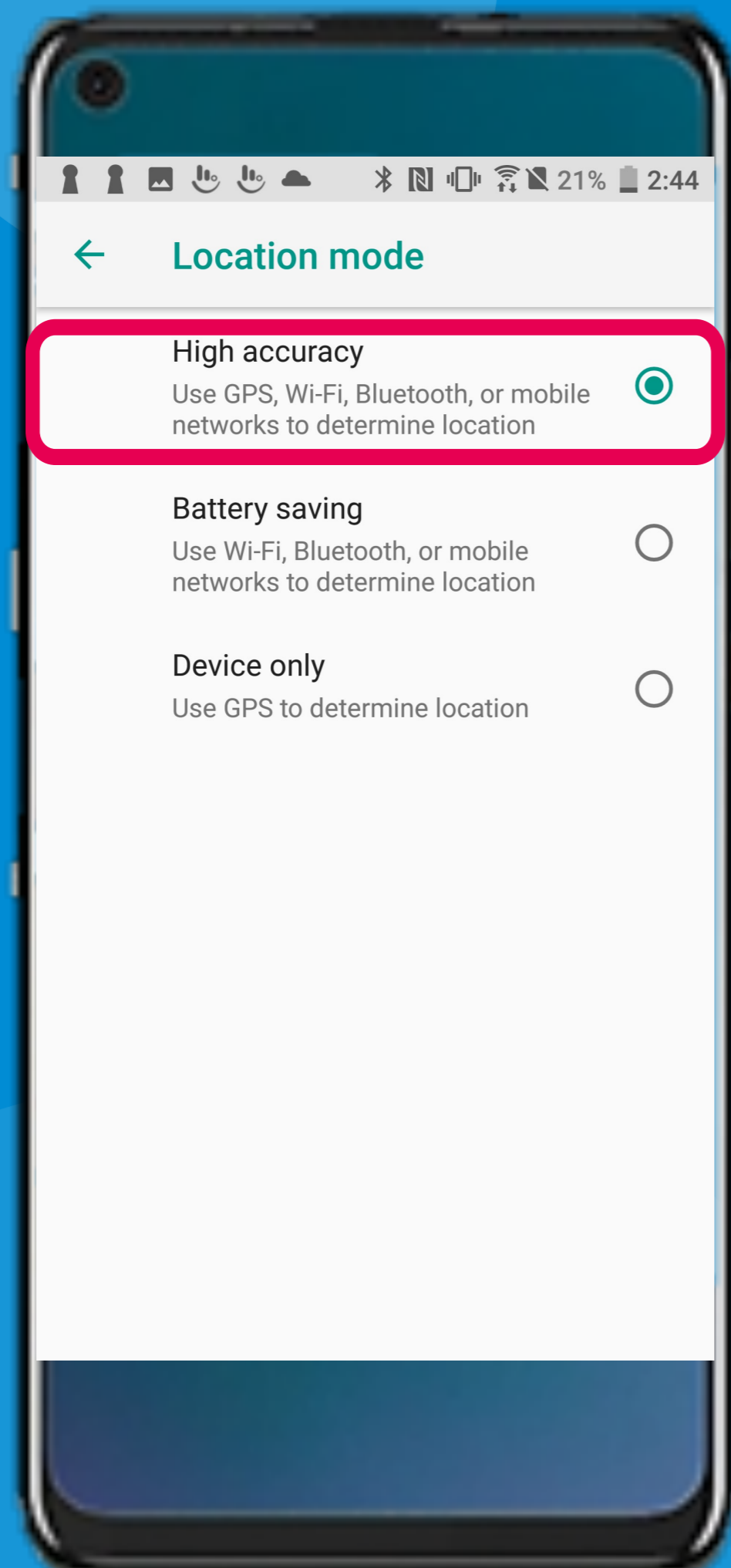

「模式」→ 選擇「高精準度」  
'Mode' → Select 'High accuracy'

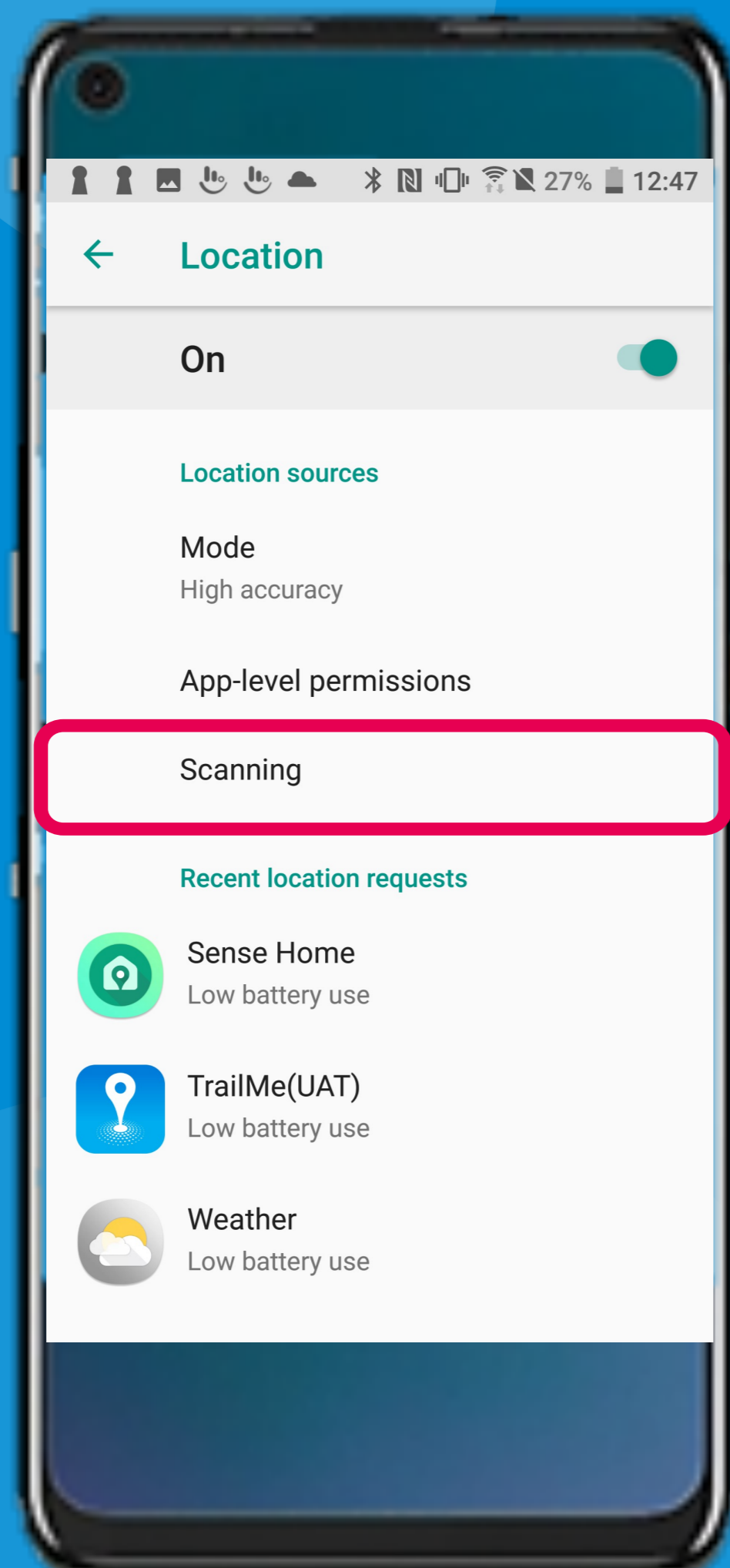

「位置」→「正在掃描」  
'Location' → 'Scanning'



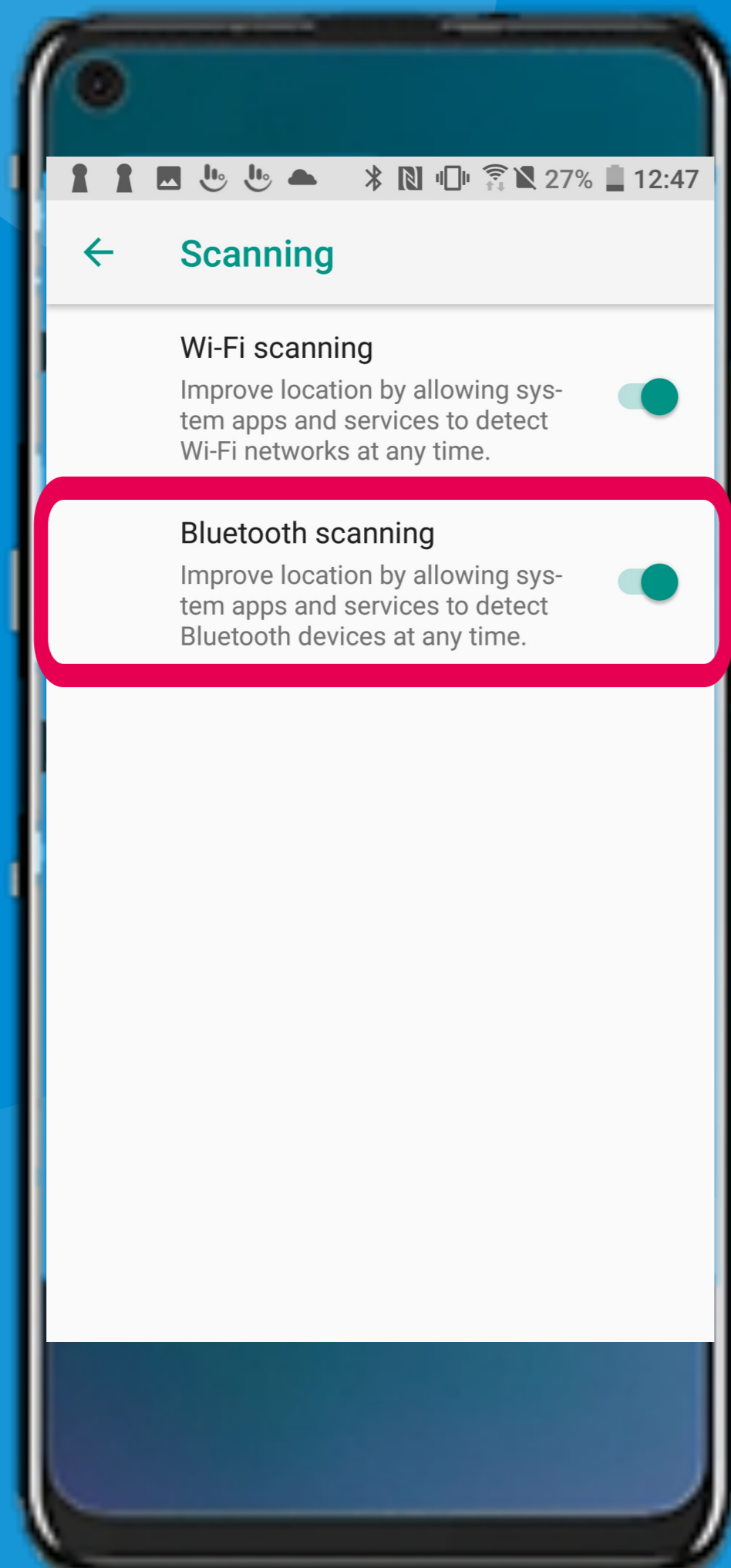

「正在掃描」 → 開啟「藍牙掃描」  
'Settings' → Turn ON 'Bluetooth scanning'

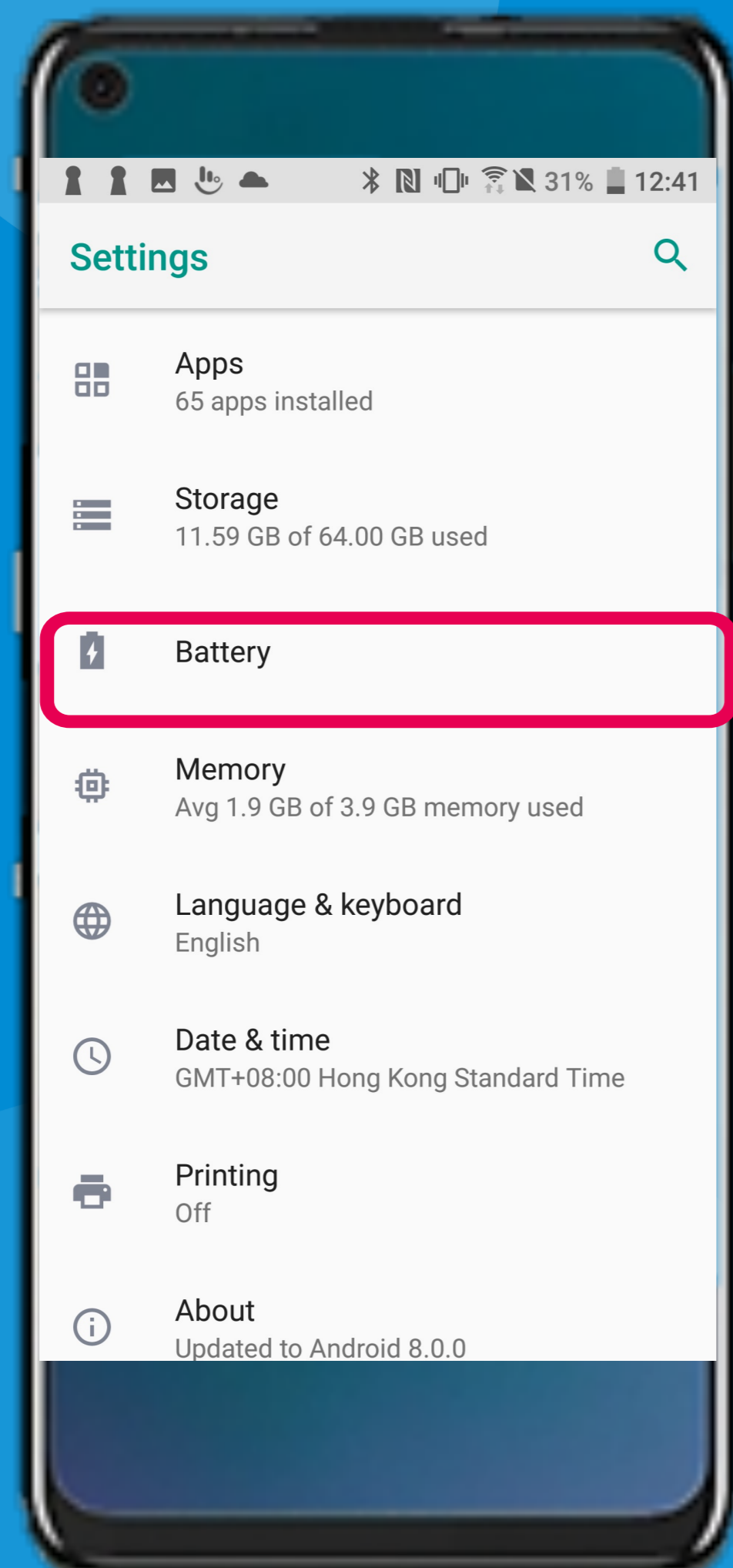

「設定」→「電池」  
'Settings' → 'Battery'

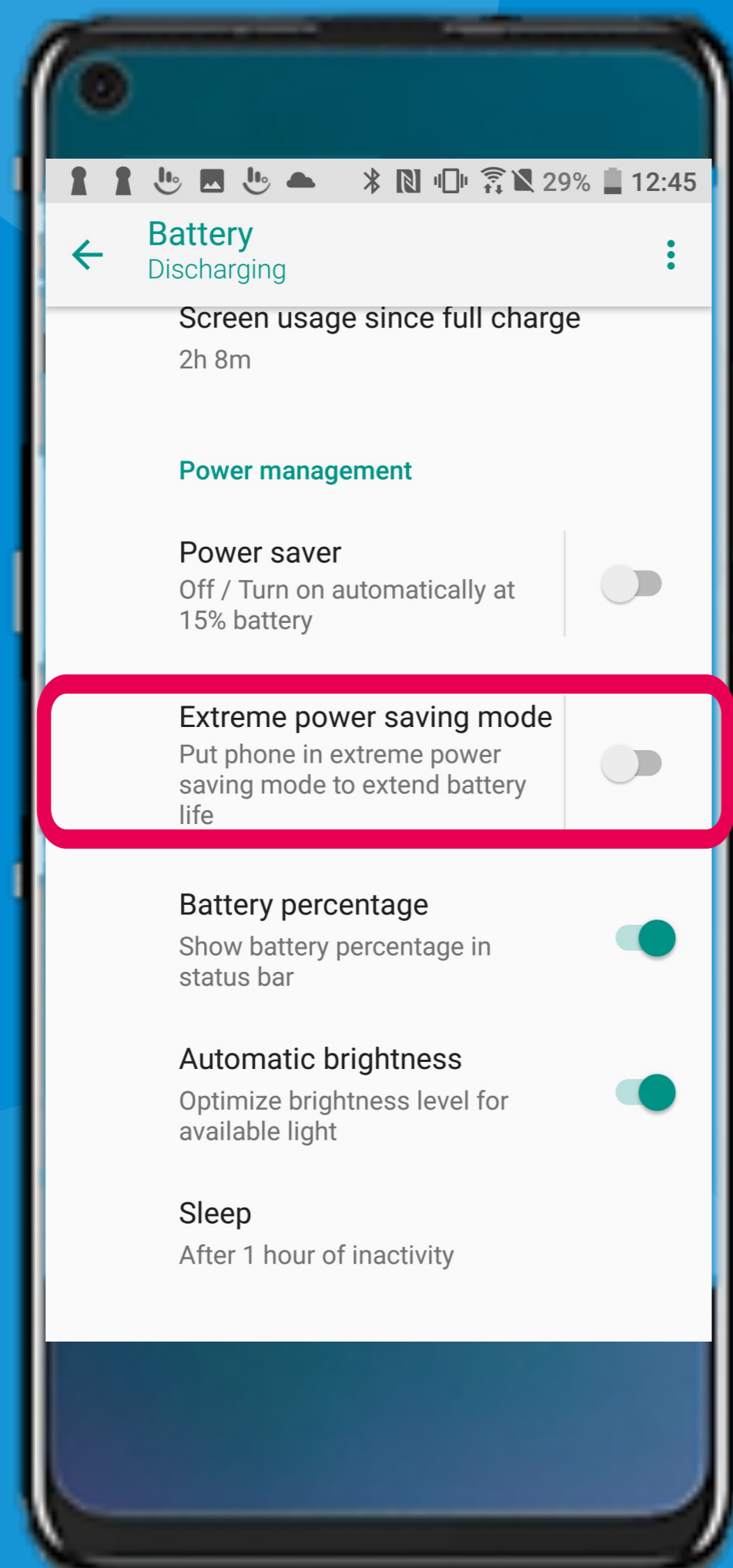

「電池」 → 關閉「極致省電模式」  
'Settings' → Turn OFF 'Extreme power saving mode'

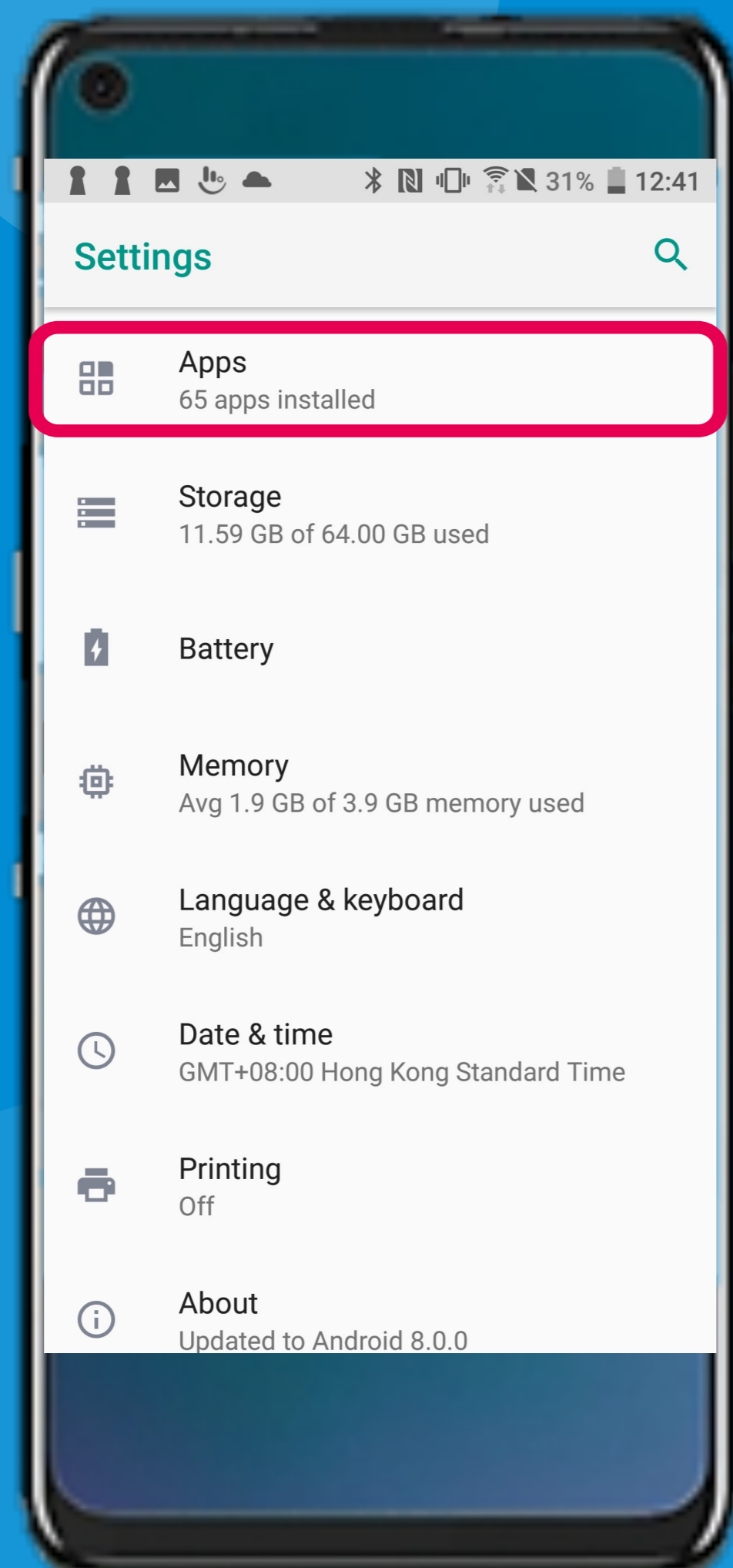

「設定」→「應用程式」  
'Settings' → 'Apps'

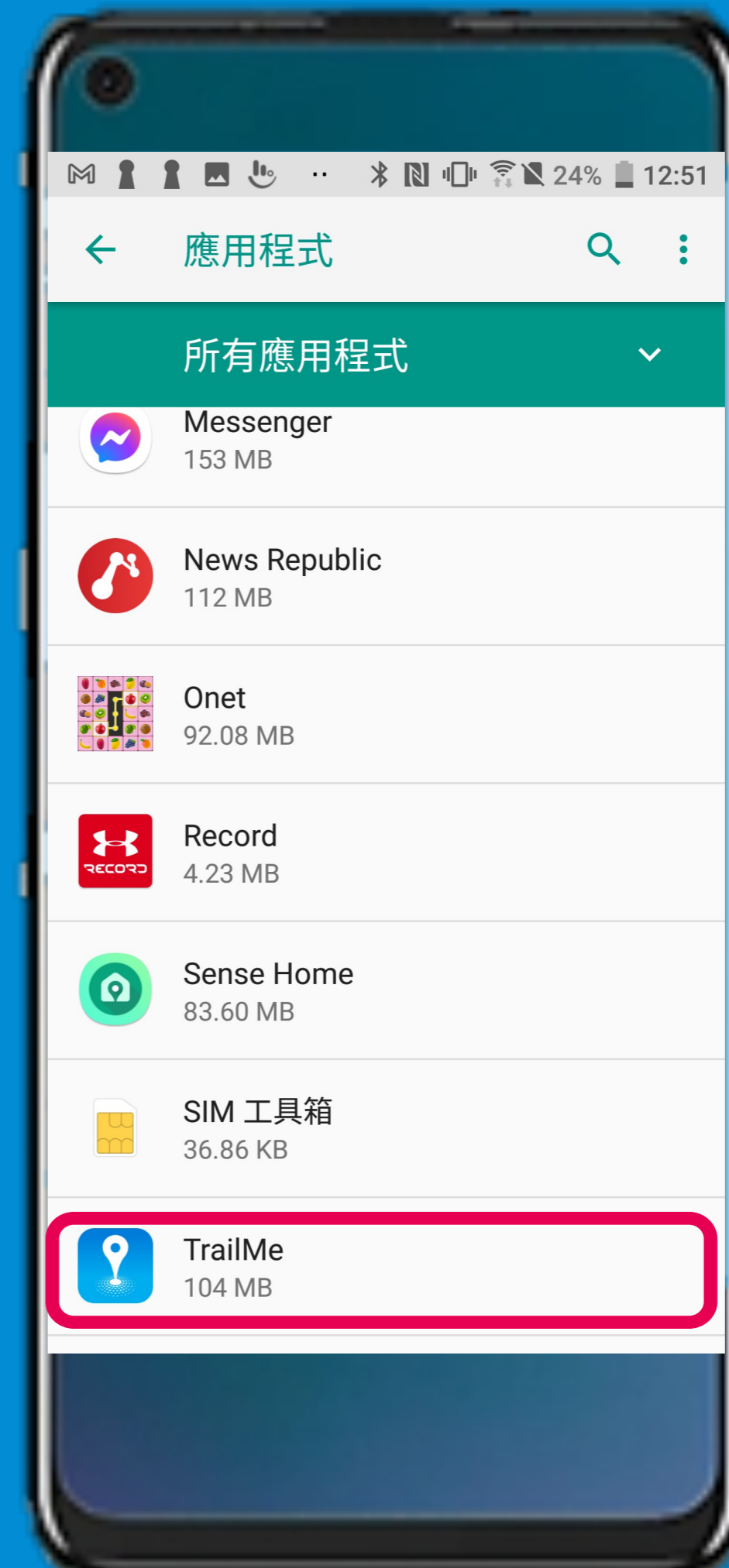
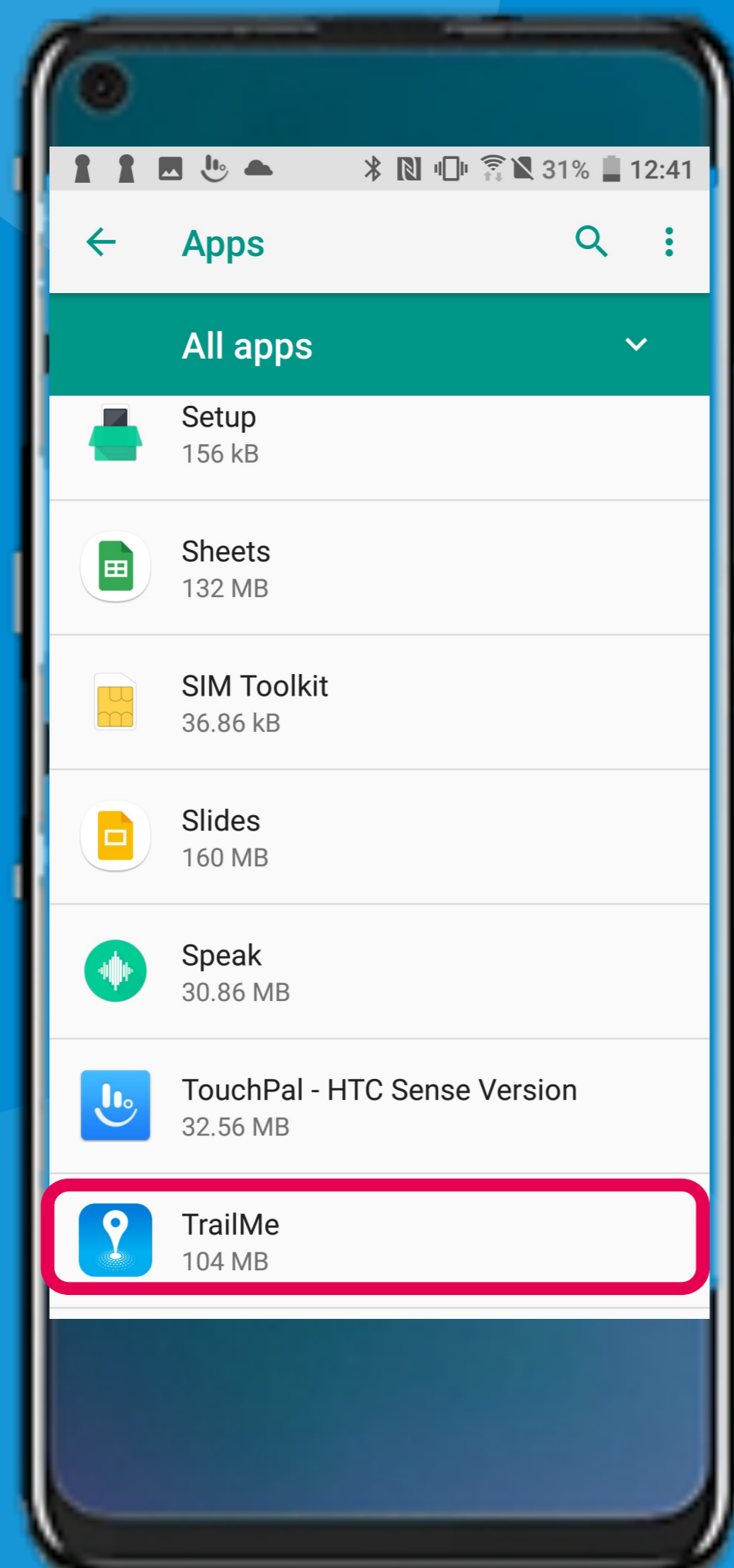

「應用程式」→ 找到 'TRAILME'  
'Settings' → Select 'TRAILME'

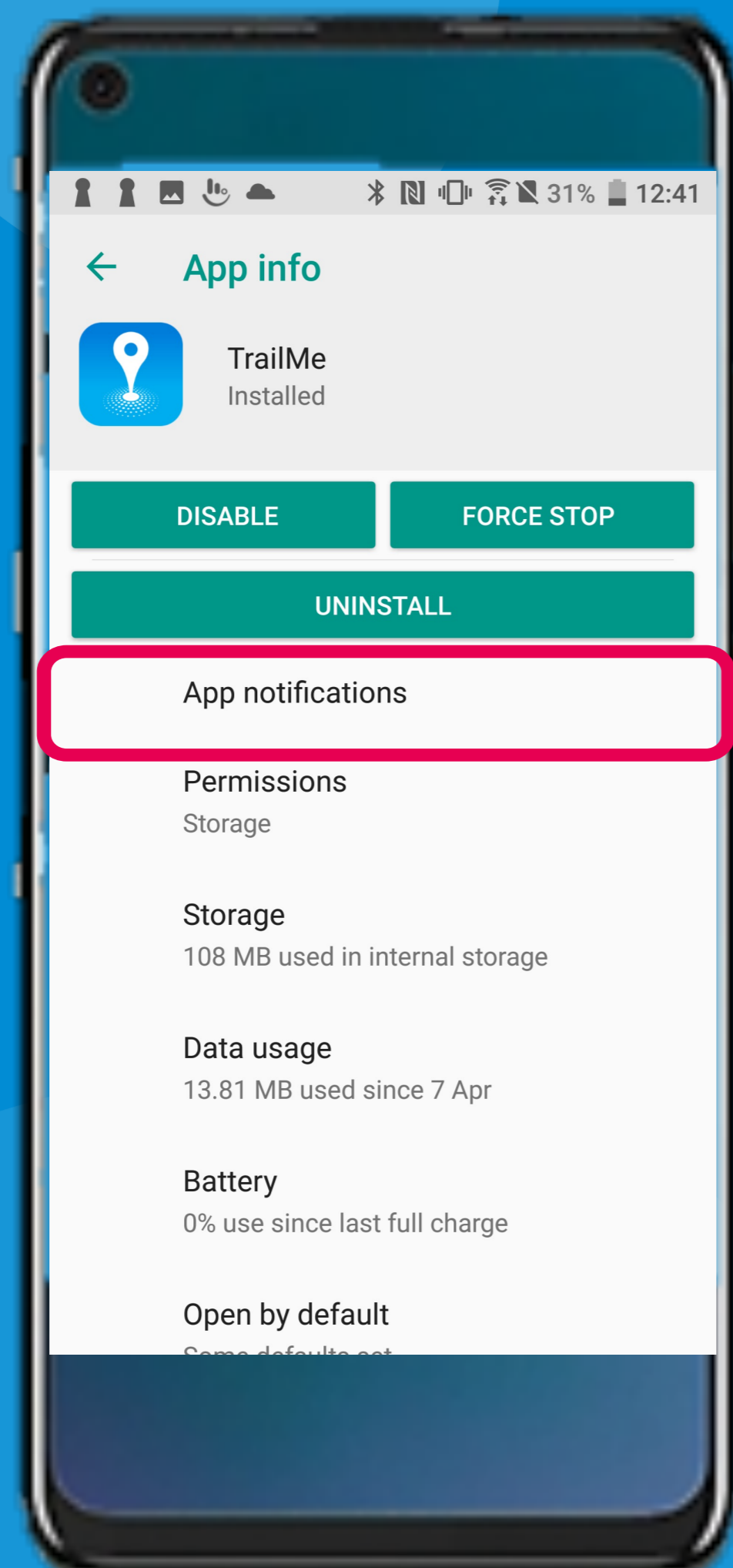

'TRAILME' → 「應用程式通知」  
'TRAILME' → 'App notification'

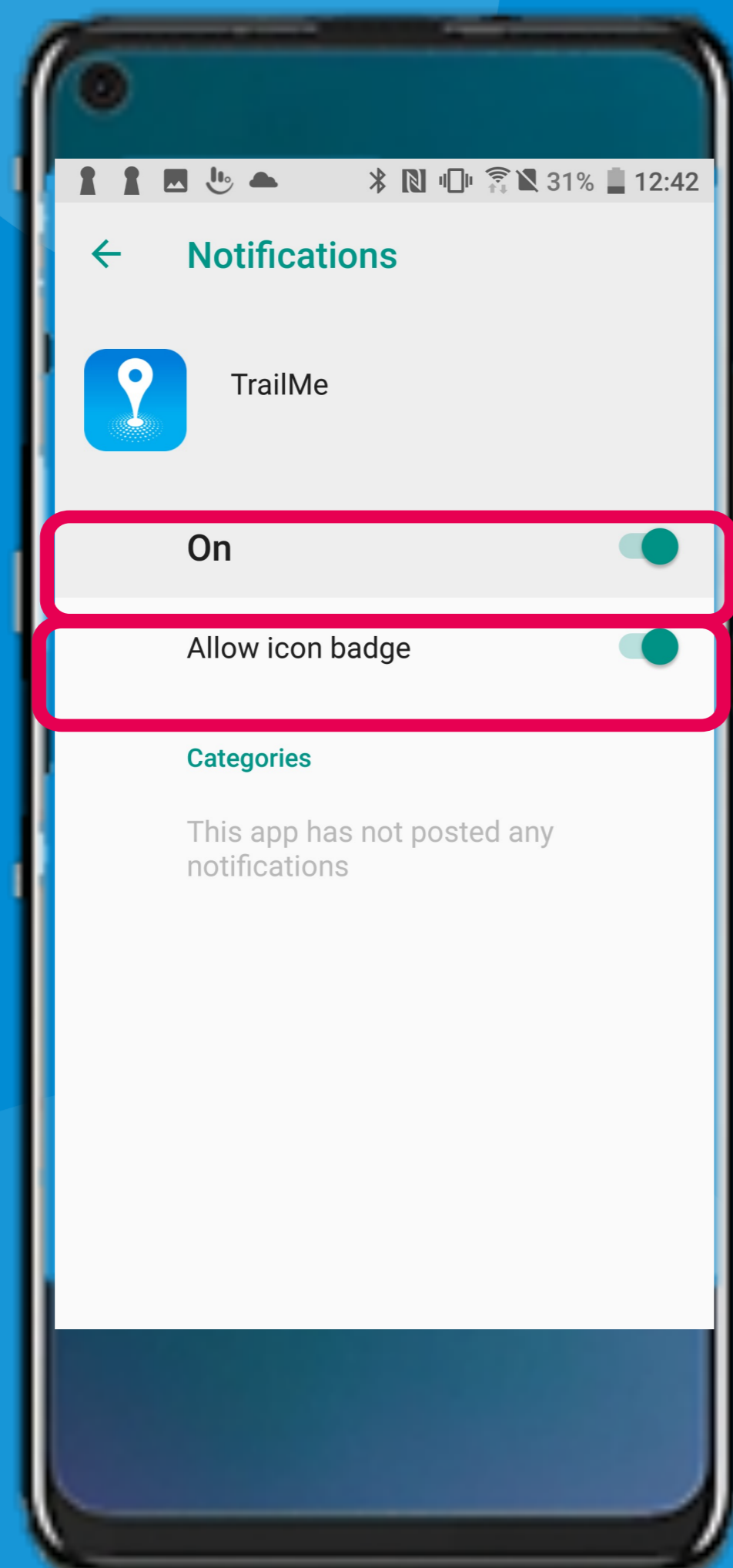

「應用程式通知」→ 開啟所有通知  
'App notification' → Turn ON all notifications

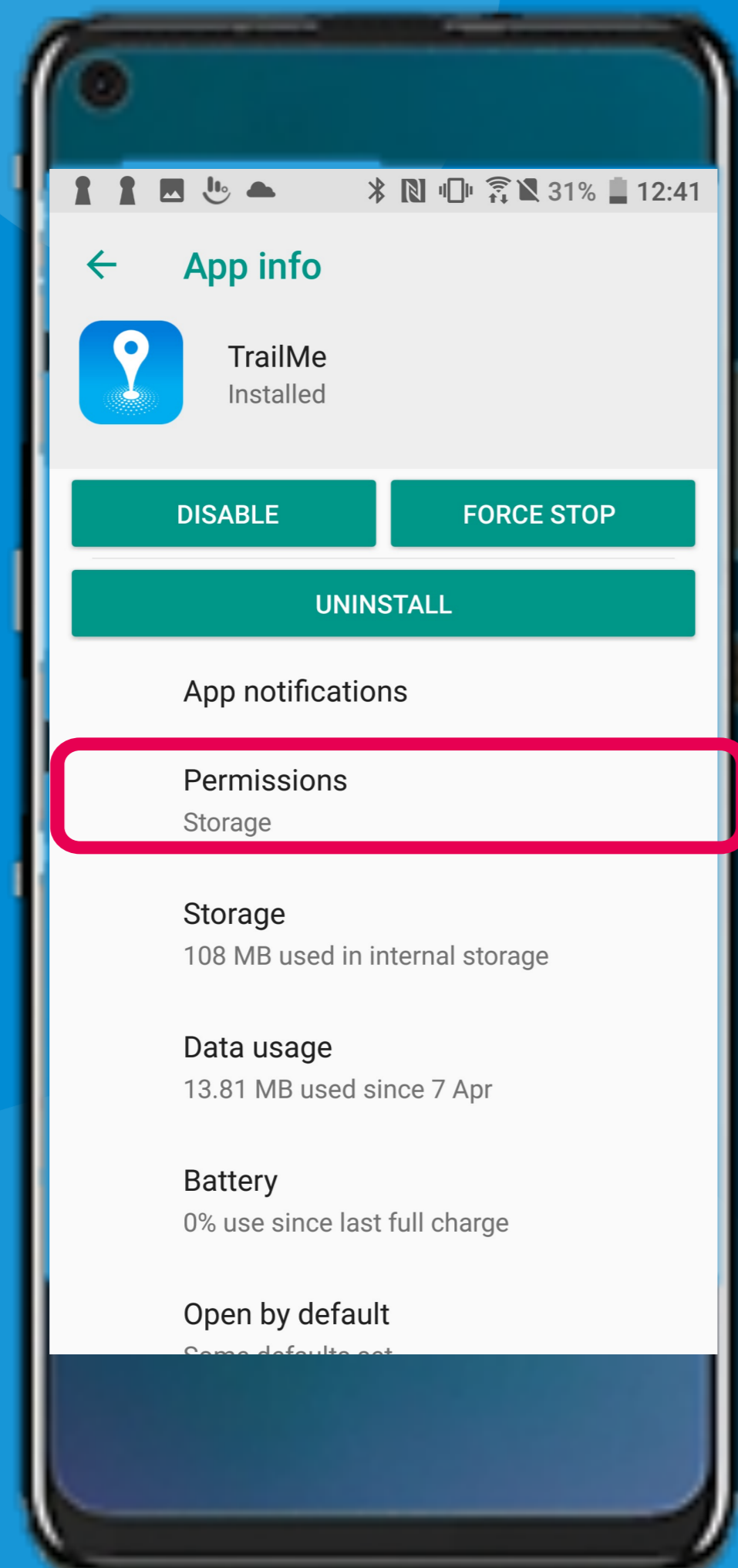

'TRAILME' → 「權限」  
'TRAILME' → 'Permissions'



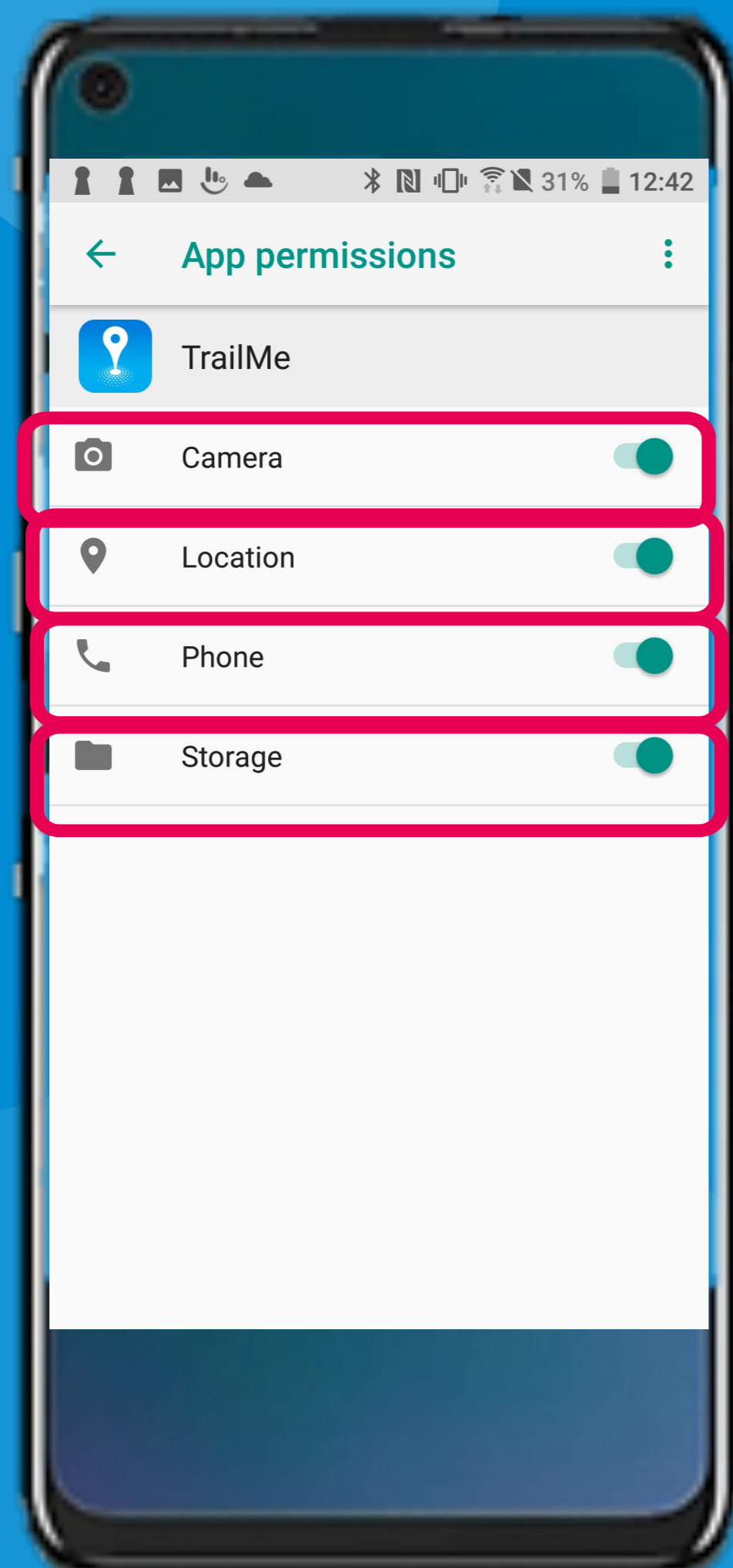

「權限」→ 允許所有權限  
'Permission' → Allow all permissions

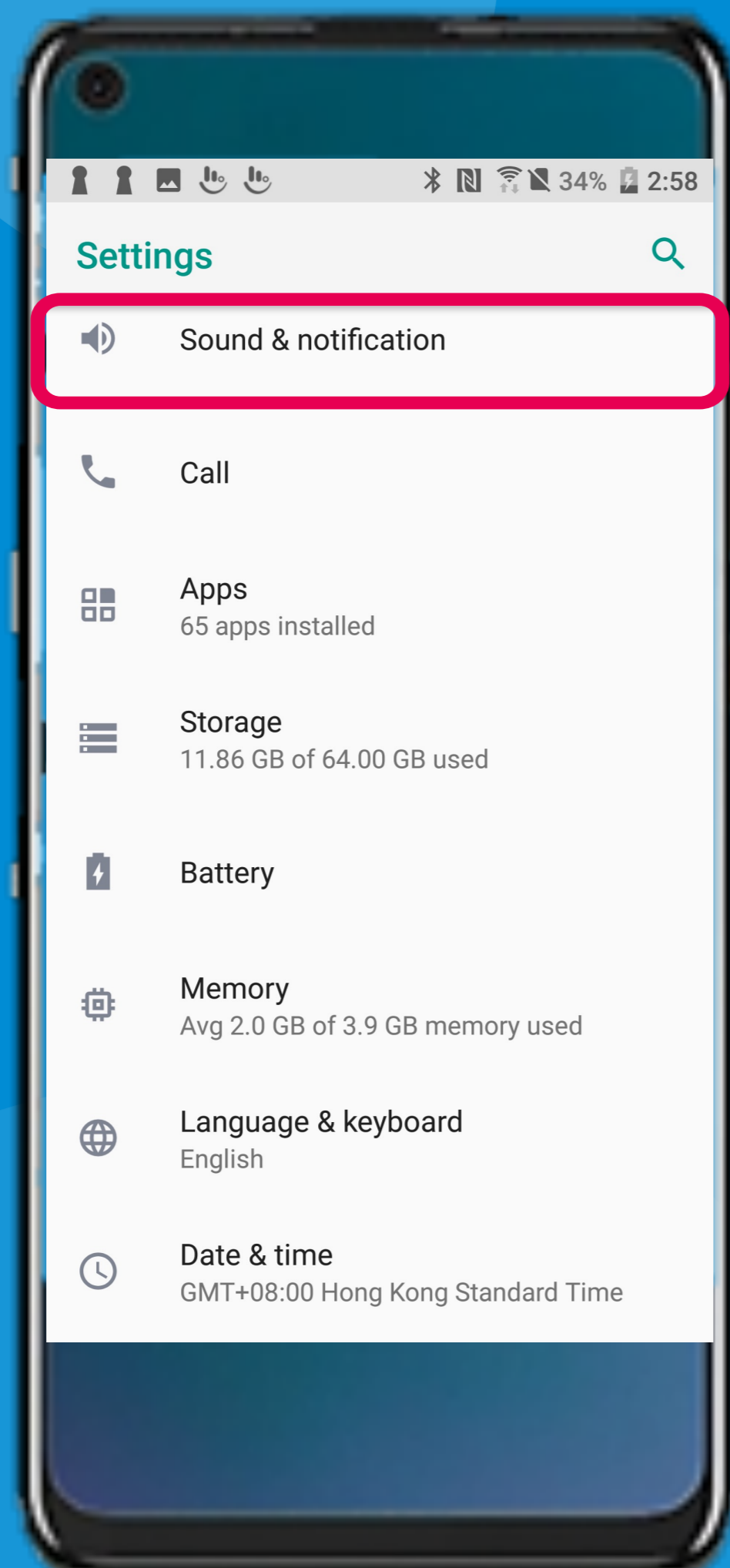

「設定」→「音效與通知」  
'Settings' → 'Sound & notification'

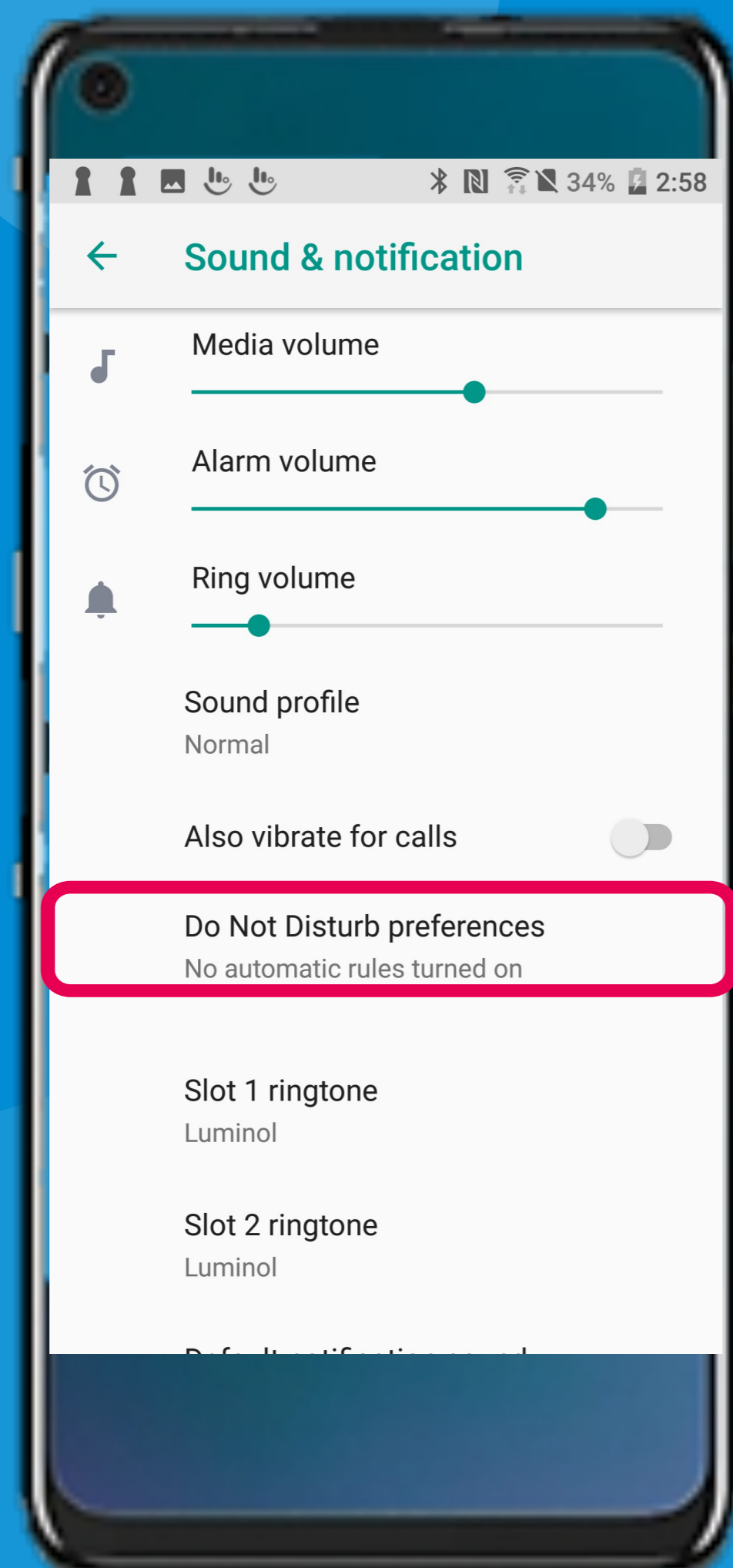

「音效與通知」 → 關閉「請勿打擾」偏好設定  
'Sound & notification' → Turn OFF 'Do Not Disturb preferences'



**TRAILME**